

RICOH

Aficio

AP2700

Setup Guide

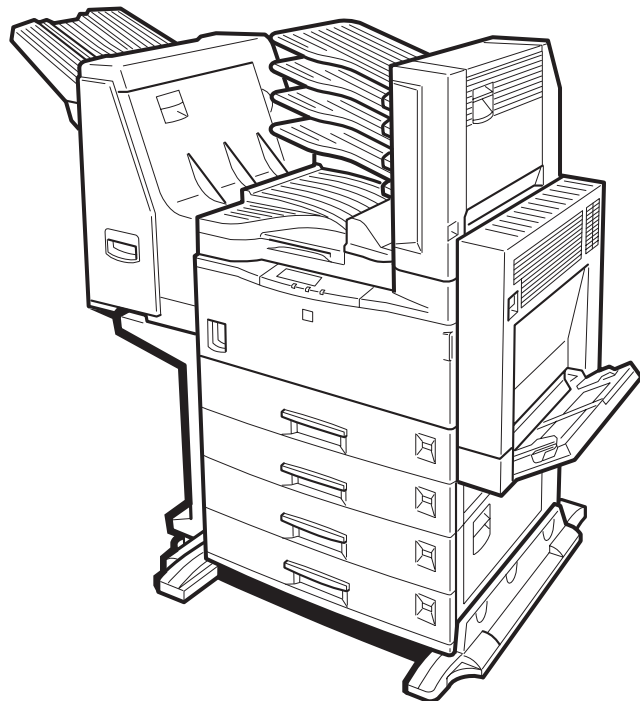

Read this manual carefully before you use this product and keep it handy for future reference.

For safety, please follow the instructions in this manual.



RICOH COMPANY, LTD.

15-5, 1 chome, Minami-Aoyama, Minato-ku, Tokyo
Telephone: Tokyo 3479-3111

Overseas Affiliates

U.S.A.

RICOH CORPORATION
5 Dedrick Place
West Caldwell, New Jersey 07006
Phone: +1-973-882-2000

The Netherlands

RICOH EUROPE B.V.
Groenelaan 3, 1186 AA, Amstelveen
Phone: +31-(0)20-5474111

United Kingdom

RICOH UK LTD.
Ricoh House,
1 Plane Tree Crescent, Feltham,
Middlesex, TW13 7HG
Phone: +44-(0)181-261-4000

Germany

RICOH DEUTSCHLAND GmbH
Mergenthalerallee 38-40,
65760 Eschborn
Phone: +49-(0)6196-9060

France

RICOH FRANCE S.A.
383, Avenue du Général de Gaulle
BP 307-92143 Clamart Cedex
Phone: +33-(0)1-40-94-38-38

Spain

RICOH ESPAÑA S.A.
Avda. Litoral Mar, 12-14,
08005 Barcelona
Phone: +34-(0)93-295-7600

Italy

RICOH ITALIA SpA
Via della Metallurgia 12,
37139 Verona
Phone: +39-045-8181500

Hong Kong

RICOH HONG KONG LTD.
23/F., China Overseas Building,
139, Hennessy Road,
Wan Chai, Hong Kong
Phone: +852-2862-2888

Singapore

RICOH ASIA PACIFIC PTE.LTD.
260 Orchard Road,
#15-01/02 The Heeren,
Singapore 238855
Phone: +65-830-5888

Model number: G038-27

Printed in The Netherlands

EE (GB) G038-8610

Introduction

This manual contains detailed instructions on the operation and maintenance of this machine. To get maximum versatility from this machine all operators should carefully read and follow the instructions in this manual. Please keep this manual in a handy place near the machine.

Please read the Safety Information before using this machine. It contains important information related to USER SAFETY and PREVENTING EQUIPMENT PROBLEMS.

Note

The names of the applications do not appear in the following pages. Confirm which applications you will be using before reading this manual.

Descriptions in this manual	Application
PRINTER MANAGER FOR ADMINIS-TRATOR	Aficio Manager for Admin
PRINTER MANAGER FOR CLIENT	Aficio Manager for Client

Power Source

220-240V, 50/60Hz, 4.5A or more

Please be sure to connect the power cord to a power source as above.

Two kinds of size notation are employed in this manual. With this machine refer to the metric version.

Ricoh shall not be responsible for any damage or expense that might result from the use of parts other than genuine Ricoh parts in your Ricoh office product.

For good copy quality, Ricoh recommends that you use genuine Ricoh toner.



Declaration of Conformity

“The Product complies with the requirements of the EMC Directive 89/336/EEC and the Low Voltage Directive 73/23/EEC.”

Caution (in case of 100BaseTX environment):

1. Properly shielded and grounded cables (STP) and connectors must be used for connections to host computer (and/or peripheral) in order to meet EMC Directive 89/336/EEC emission limits.
2. STP with ferrite core must be used for RF interference suppression.

In accordance with IEC 60417, this machine uses the following symbols for the main power switch:

I means **POWER ON.**

O means **POWER OFF.**

Introduction

This manual contains detailed instructions on the operation and maintenance of this machine. To get maximum versatility from this machine all operators should carefully read and follow the instructions in this manual. Please keep this manual in a handy place near the machine.

Please read the Safety Information before using this machine. It contains important information related to USER SAFETY and PREVENTING EQUIPMENT PROBLEMS.

Note

The names of the applications do not appear in the following pages. Confirm which applications you will be using before reading this manual.

Descriptions in this manual	Application
PRINTER MANAGER FOR ADMINISTRATOR	Aficio Manager for Admin
PRINTER MANAGER FOR CLIENT	Aficio Manager for Client

Power Source

220-240V, 50/60Hz, 4.5A or more

Please be sure to connect the power cord to a power source as above.

Two kinds of size notation are employed in this manual. With this machine refer to the metric version.

Supplier shall not be responsible for any damage or expense that might result from the use of parts other than genuine supplier's parts in your supplier's office product.

For good copy quality, supplier recommends that you use genuine supplier's toner.

Read this manual carefully before you use this product and keep it handy for future reference.

For safety, please follow the instructions in this manual.



Declaration of Conformity

“The Product complies with the requirements of the EMC Directive 89/336/EEC and the Low Voltage Directive 73/23/EEC.”

Caution (in case of 100BaseTX environment):

1. Properly shielded and grounded cables (STP) and connectors must be used for connections to host computer (and/or peripheral) in order to meet EMC Directive 89/336/EEC emission limits.
2. STP with ferrite core must be used for RF interference suppression.

In accordance with IEC 60417, this machine uses the following symbols for the main power switch:

I means POWER ON.

O means POWER OFF.

Trademarks

Microsoft[®], Windows[®], and MS-DOS[®] are registered trademarks of Microsoft Corporation in the United States and/or other countries.

PostScript[®] is a registered trademark of Adobe Systems, Incorporated.

PCL[®] is a registered trademark of Hewlett-Packard Company.

AppleTalk, Apple, Macintosh, TrueType, LaserWriter are registered trademarks of Apple Computer, Incorporated.

Ethernet[®] is a registered trademark of Xerox Corporation.

Other product names used herein are for identification purposes only and might be trademarks of their respective companies. We disclaim any and all rights involved with those marks.

Notes:

Some illustrations might be slightly different from your machine.

Certain options might not be available in some countries. For details, please contact your local dealer.

Note

The proper names of the Windows operating systems are as follows:

- Microsoft[®] Windows[®] 95 operating system
- Microsoft[®] Windows[®] 98 operating system
- Microsoft[®] Windows[®] for Workgroups operating system Version 3.11
- Microsoft[®] Windows NT[®] Server network operating system Version 4.0
- Microsoft[®] Windows NT[®] Workstation operating system Version 4.0

ENERGY STAR Program

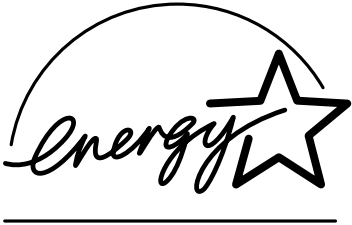
	<p>As an ENERGY STAR Partner, we have determined that this machine model meets the ENERGY STAR Guidelines for energy efficiency.</p>
-----------------------------------------------------------------------------------	--------------------------------------------------------------------------------------------------------------------------------------

The ENERGY STAR Guidelines intend to establish an international energy-saving system for developing and introducing energy-efficient office equipment to deal with environmental issues, such as global warming.

When a product meets the ENERGY STAR Guidelines for energy efficiency, the Partner shall place the ENERGY STAR logo onto the machine model.

This product was designed to reduce the environmental impact associated with office equipment by means of energy-saving features, such as Low-power mode.

❖ **Low-power Mode (Energy Saver Mode)**

This printer automatically lowers its power consumption 10 or 15 minutes after the last operation has been completed. To exit Low-power (Energy Saver) mode, press any key on the operation panel. To change the setting of the Energy Saver mode, see “Using the Operation Panel” in the “Printer Reference”.

❖ **Specifications**

Energy Saver mode 1	Power Consumption	40W or less
	Default Time	10 minutes
	Recovery Time	100 seconds or less
Energy Saver mode 2	Power Consumption	25W or less
	Default Time	15 minutes
	Recovery Time	100 seconds or less



 **Recycled Paper**

Please contact your sales or service representative for recommended recycled paper types that may be used in this machine.



Manuals for this Printer

Manuals for this Printer

There are five manuals that come with this printer.

To enhance safe and efficient operation of your printer, all users should read and follow the instructions contained in the following manuals.

❖ **Setup Guide**

Describes the procedures for installing your printer. (This Manual)

❖ **Printer Reference**

Describes the procedures and provides necessary information on using your printer and its options.

❖ **PostScript 3 Operating Instructions Supplement**

Describes the menus and features you can set using the PostScript printer driver. The manual is provided as a PDF file which is included in the CD-ROM labeled "Printer Drivers and Utilities".

❖ **Network Interface Board Operating Instructions**

Describes the procedures and provides necessary information on setting up and using your printer under the network environment. The manual is provided as a PDF file which is included in the CD-ROM labeled "Printer Drivers and Utilities".

❖ **PortNavi Operating Instructions Supplement**

Describes the procedures for using PortNavi. The manual is provided as a PDF file which is included in the CD-ROM labeled "Printer Drivers and Utilities".

How to Read this Manual

Symbols

In this manual, the following symbols are used:

 **WARNING:**

This symbol indicates a potentially hazardous situation which, if instructions are not followed, could result in death or serious injury.

 **CAUTION:**

This symbol indicates a potentially hazardous situation which, if instructions are not followed, may result in minor or moderate injury or damage to property.

* The statements above are notes for your safety.

 **Important**

If this instruction is not followed, paper might be misfed, originals might be damaged, or data might be lost. Be sure to read this.

 **Preparation**

This symbol indicates the prior knowledge or preparations required before operating.

 **Note**

This symbol indicates precautions for operation, or actions to take after misoperation.

 **Limitation**

This symbol indicates numerical limits, functions that cannot be used together, or conditions in which a particular function cannot be used.

 **Reference**

This symbol indicates a reference.

[]

Keys that appear on the machine's panel display.

Keys and buttons that appear on the computer's display.

【 】

Keys built into the machine's operation panel.

Keys on the computer's keyboard.

TABLE OF CONTENTS

1. Setting Up the Printer

Unpacking the Printer and Checking the Contents of the Box	1
Where to Put the Printer	4
Installing Options	6
Available Options	8
Installing PS400/PS440/PS420 (Paper Feed Unit)	10
Installing Interchange Unit Type 280	13
Installing AD370 (Duplex Unit)	16
Installing Bypass Tray Type 270	19
Installing CS370 (Mailbox)	22
Installing Printer Feature Expander Type 185	24
Installing Printer Hard Disk Type 185	25
Installing the Toner Bottle	27
Loading Paper	29
Loading Paper on the Paper Tray	29
Loading Paper on PS420 (Paper Feed Unit)	31
Loading Paper on Bypass Tray Type 270	32
Connecting the Power Cord	35
Selecting the Panel Display Language	36
Printing a Configuration Page	37
Interpreting a Configuration Page	38
Connecting the Printer	40
Requirements	40
Connecting the Printer to the Network	42
Connecting the Printer to the Host Using a Parallel Cable	44

2. Configuring the Printer for the Network

Configuring the Printer for the Network with the Operation Panel	45
-------------------------------------------------------------------------------	-----------

3. Installing the Printer Driver and Software

Auto Run	51
Installing by Auto Run	52
Software and Utilities Included on the CD-ROM	53
Installing the PCL 6/5e Printer Driver	55
Windows 95/98 - Installing the PCL 6/5e Printer Driver	55
Windows NT 4.0 - Installing the PCL 6/5e Printer Driver	55
Windows 3.1x - Installing the PCL 6/5e Printer Driver	56
Installing the PostScript Printer Driver	58
Windows 95/98 - Installing the PostScript Printer Driver	58

Windows NT 4.0 - Installing the PostScript Printer Driver	58
Windows 3.1x - Installing the PostScript Printer Driver	59
Using Adobe PageMaker Version 6.0 or 6.5.....	61
Macintosh.....	62
Macintosh - Installing the PostScript Printer Driver	62
Setting Up the PPD File	63
Setting Up Options	63
INDEX.....	64

1. Setting Up the Printer

Unpacking the Printer and Checking the Contents of the Box

CAUTION:

- To prevent injuries, this printer should be lifted by at least two people.

1 Check the contents of the box according to the following list. If one or more items are missing, please contact your sales or service representative.

- Setup Guide (this manual)
- Printer Reference
- Additional documentation
- CD-ROM labeled "Printer Driver and Utilities"
- Power cord
- Ferrite core
- Paper size seal
- Tray number seal

Important

- The interface cable is not supplied in the box. It is your responsibility to provide the interface cable appropriate for the computer that you are using. ⇒ P.40 "Connecting the Printer"
- The toner bottle is not included in the box. Consult your sales or service representative about the toner bottle.

2 Remove the adhesive tape from the printer as shown in the illustration.

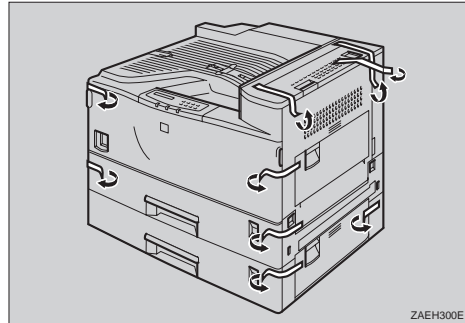

Note

- Do not remove the adhesive tape from the power cord, if you want to install the optional paper feed unit.

3 Slide tray 2 out (①), and release the side guide adhesive lever (②), and then slide the side guide while pressing the release lever (③).

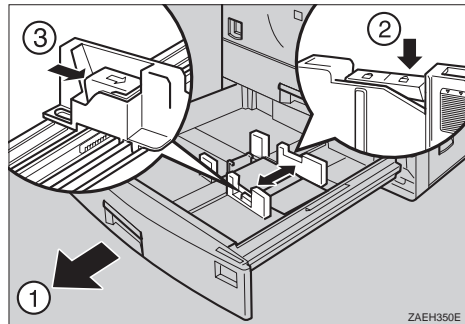

1

4 Remove the adhesive tape.

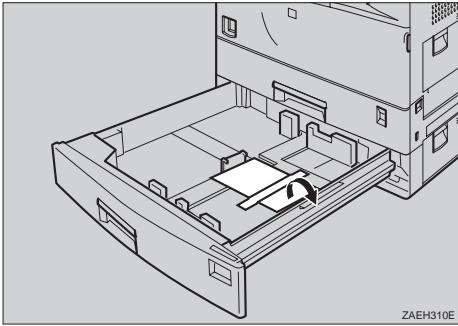

8 Open the front cover.

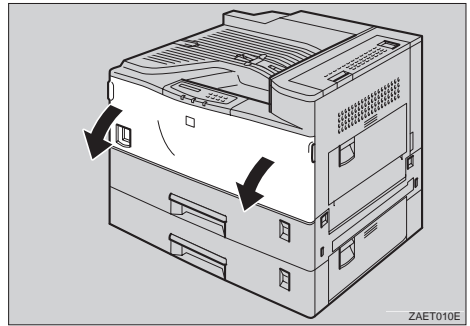

5 Slide tray 1 out (①), and release the side guide adhesive lever (②), and then slide the side guide while pressing the release lever (③).

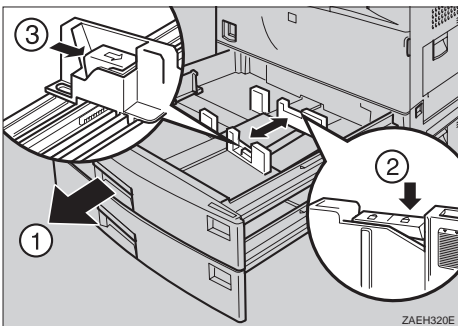

9 Remove the red tag on the photo conductor unit slightly, and remove the metal fitting and the two tags.

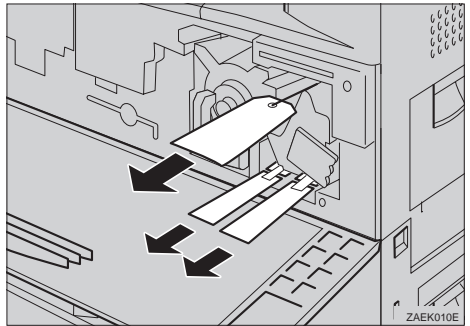

6 Remove the adhesive tape.

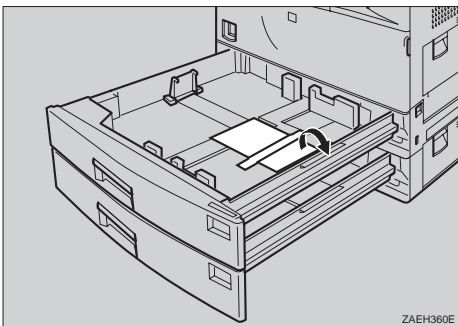

Important

- ❑ Be sure to remove the red tag from the photo conductor unit. An error message will appear on the panel display, if you turn on the printer power before the red tag is not removed.

10 Close the front cover.

7 Slide tray 1 and tray 2 into the printer until they stop.

- 11** Set the paper sensor within the output tray on the top of the printer as shown in the illustration.

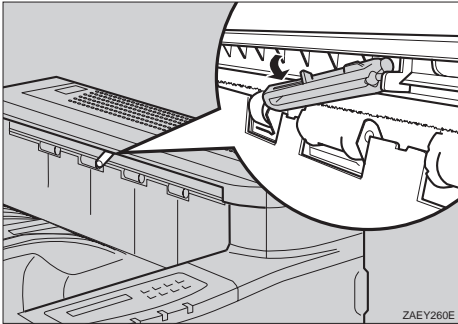

- 12** Put the paper size seal directly below the paper size display of the front on the paper tray.

Unpacking the printer is finished. For more information on installing options, see P.6 "Installing Options".

Where to Put the Printer

1

1 Your printer's location should be carefully chosen because environmental conditions can greatly affect its performance.

⚠ WARNING:

- **Confirm that the wall outlet is near the machine and freely accessible, so that in the event of an emergency, it can be easily unplugged.**
- **Only connect the machine to the power source described on this sheet.**
- **Avoid multi-wiring.**
- **Do not damage, break or make any modifications to the power cord. Do not place heavy objects on it, pull it hard or bend it more than necessary. These actions could damage the cord. A frayed or damaged cord might cause an electrical and fire hazard.**

⚠ CAUTION:

- *Do not handle the plug with wet hands. Doing this might cause an electrical shock.*
- *Keep the machine in an area that is within optimum environmental conditions. Operating the machine in an environment that is outside the recommended ranges of humidity and temperature can cause an electrical or fire hazard. Keep the area around the socket free of dust. Accumulated dust can become an electrical or fire hazard.*
- *Place the machine on a strong and level surface. Otherwise, the machine might fall and injure someone.*
- *If you use the machine in a confined space, confirm there is a continuous air turnover.*

❖ Optimum Environmental Conditions

The recommended temperature and humidity

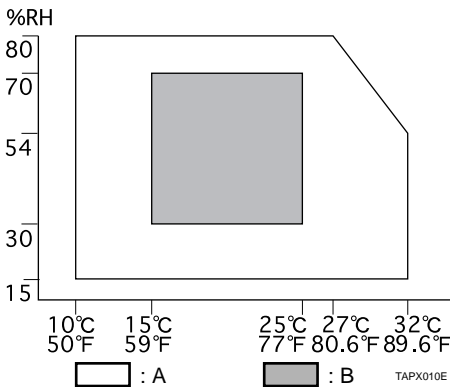

A: Possible operation range

B: Recommended range

The machine must be level within 5mm, 0.2" both front to rear and left to right.

To avoid possible build-up of ozone, locate this machine in a large well ventilated room that has an air turnover of more than 30m³/hr/person.

1

❖ Space Required for Installation

Leave enough space around the printer. This space is necessary to operate the printer. The recommended (or minimum) space requirements are as follows:

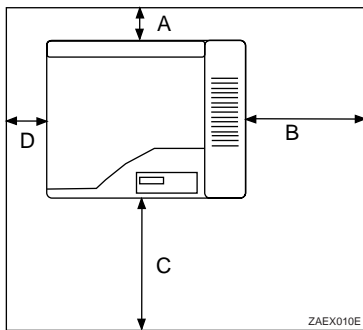

A: more than 10cm (4.0")

B: more than 45cm (17.8")

C: more than 75cm (29.6")

D: more than 10cm (4.0")

2 Environments to Avoid

⚠ Important

- Locations exposed to direct sunlight or strong light
- Dusty areas
- Areas with corrosive gases
- Areas excessively cold, hot, or humid
- Locations near an air conditioner or humidifier
- Locations near other electronic equipment
- Locations where the printer might be subjected to frequent strong vibration

3 Power Source

Connect the power cord to a power source with the following specifications:

- 220-240V, 50/60Hz, 4.5A or more

Installing Options

1

⚠ CAUTION:

- *Before installing options, the machine should be turned off and unplugged for at least thirty minutes. Components inside the machine become very hot, and can cause a burn injury if touched.*
- *Before moving the machine, unplug the power cord from the outlet. If the cord is unplugged abruptly, it could become damaged. Damaged plugs or cords can cause an electrical or fire hazard.*
- *When lifting the machine, use the grips on both sides. The machine could break or cause an injury if dropped.*

You can increase the functionality of the printer by adding options. See "Options" in the "Printer Reference" to confirm what kind of options are available.

If you intend to install options, options should be installed in the order described below.

⚠ Important

- Rating voltage of the connector for options; Max. DC24V.

📌 Note

- If you want to install SR720 (finisher), Bridge Unit Type 270 and PS420 or PS440 are required.
- If you want to install Bridge Unit Type 270 and SR720 (finisher), contact your sales or service representative.

❖ Option Installation Order

1 Installing the paper feed unit ▼	There are three types of paper feed units: PS400 (500-sheet paper feed unit), PS440 (1000-sheet paper feed unit) and PS420 (2000-sheet paper feed unit). Only one of them can be installed at one time. ⇒ P.10 <i>“Installing PS400/PS440/PS420 (Paper Feed Unit)”</i>
2 Installing Interchange Unit Type 280 ▼	Interchange Unit Type 280 is used for AD370 (duplex unit) or CS370 (mailbox). If you intend to install AD370 (duplex unit) or CS370 (mailbox), Interchange Unit Type 280 must be installed first. ⇒ P.13 <i>“Installing Interchange Unit Type 280”</i>
3 Installing AD370 (duplex unit) ▼	Install AD370 (duplex unit) on the right side of the printer, after installing Interchange Unit Type 280. ⇒ P.16 <i>“Installing AD370 (Duplex Unit)”</i>
4 Installing Bypass Tray Type 270 ▼	Install Bypass Tray Type 270 on the right side of the printer. ⇒ P.19 <i>“Installing Bypass Tray Type 270”</i>
5 Installing CS370 (mailbox) ▼	Install CS370 (mailbox) on top of Interchange Unit Type 280, after installing Interchange Unit Type 280. ⇒ P.22 <i>“Installing CS370 (Mailbox)”</i>
6 Installing Printer Feature Expander Type 185 ▼	There are two types of Printer Feature Expander Type 185, 32MB and 64MB. Only one of them can be installed at one time. ⇒ P.24 <i>“Installing Printer Feature Expander Type 185”</i>
7 Installing Printer Hard Disk Type 185	⇒ P.25 <i>“Installing Printer Hard Disk Type 185”</i>

Available Options

The following options can be installed on your printer.

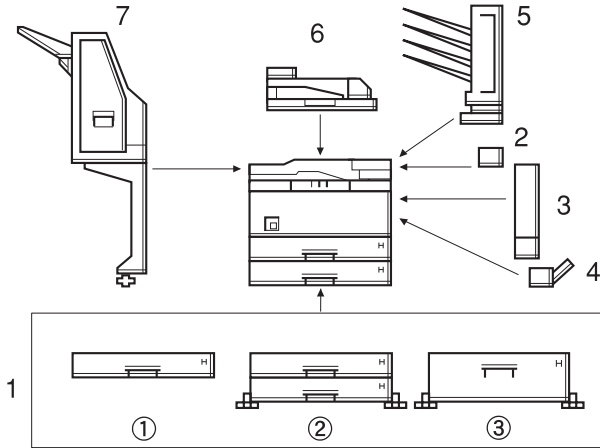

ZAEP450E

1. Paper Feed Units

Place the printer on the paper feed unit and fasten the screws that join the printer and the paper feed unit. There are three types of paper feed units that are described below. Only one of them can be installed at one time.

①PS400

With this option, you can load 500 sheets.

②PS440

With this option, you can load 1000 sheets.

③PS420

With this option, you can load 2000 sheets.

2. Interchange Unit Type 280

With this option, the printed paper is sent to AD370 (duplex Unit) or CS370 (mailbox).

3. AD370 (Duplex Unit)

With this option, you can print on both sides of paper. Install AD370 (duplex Unit) on the right side of the printer, after installing Interchange Unit Type 280.

4. Bypass Tray Type 270

With this option, you can print on paper that is custom size or thick type. You can load 100 sheets.

5. CS370 (Mailbox)

With this option, the printed paper can be sent to four output trays. Install CS370 (mailbox) on the top of Interchange Unit Type 280, after installing Interchange Unit Type 280.

6. Bridge Unit Type 270

With this option, the printed paper is sent to SR720 (finisher). If you want to install Bridge Unit Type 270, contact your sales or service representative.

7. SR720 (Finisher)

With this option, the printed paper can be sorted or stapled. If you want to install SR720 (finisher), contact your sales or service representative.

Note

- ❑ If you want to install SR720 (finisher), Bridge Unit Type 270 and PS420 or PS440 are required.

Reference

For more information on the parts name of the printer, see “Guide to the Printer” in the “Printer Reference”.

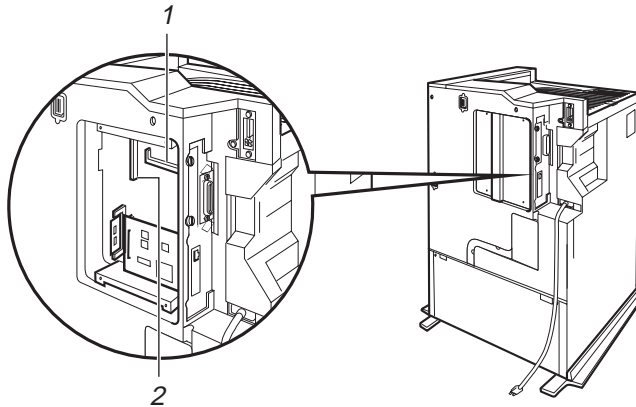

ZAEP461E

1. Printer Feature Expander Type 185 (32MB or 64MB)

Install the memory unit into the slots on the printer board.

2. Printer Hard Disk Type 185

Install Printer Hard Disk Type 185 into the slots on the printer board.

Installing PS400/PS440/PS420 (Paper Feed Unit)

1

⚠ CAUTION:

- Before installing options, the machine should be turned off and unplugged for at least thirty minutes. Components inside the machine become very hot, and can cause a burn injury if touched.
- When lifting the machine, use the grips on both sides. The machine could break or cause an injury if dropped. It is dangerous to handle the plug with wet hands. Doing this may result in receiving an electric shock.
- Before moving the machine, unplug the power cord from the outlet. If the cord is unplugged abruptly, it could become damaged. Damaged plugs or cords can cause an electrical or fire hazard.

There are three types of paper feed units: PS400 (500-sheet paper feed unit), PS440 (1000-sheet paper feed unit) and PS420 (2000-sheet paper feed unit). Only one of them can be installed at one time. The installation of PS440 is described below.

⚠ Important

- If you want to change the paper size of PS420, contact your sales or service representative.

1 Confirm that the box contains the following items.

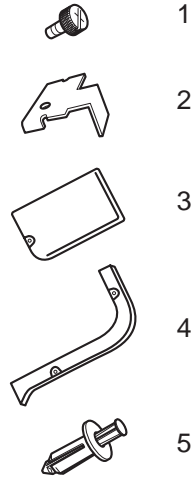

- 1. Screws (4 pcs)
- 2. Securing brackets (2 pcs)
- 3. Cover 1
- 4. Cover 2
- 5. Screws (3 pcs)
 - Installation Guide

✎ Note

- The paper size seal and the tray number seal are included only with the printer.

2 Turn off the printer, and remove all cables and cords from the printer.

ZAEP380E

- 3** Remove the adhesive tape and the packing materials.

Important

- Remove the adhesive tape fixing the cable and the paper feed unit after placing the printer.

❖ PS400

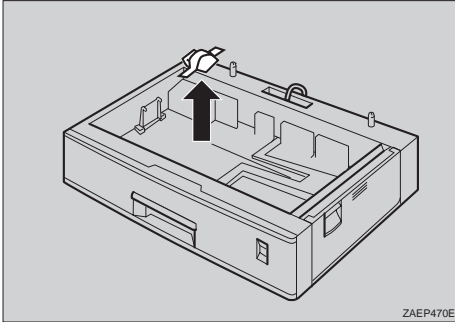

❖ PS440

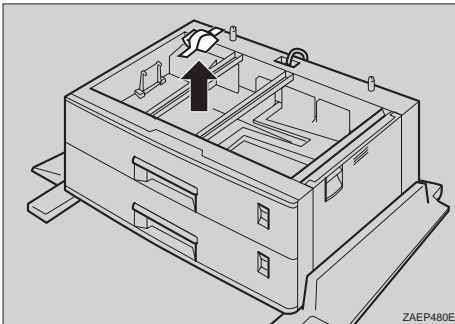

❖ PS420

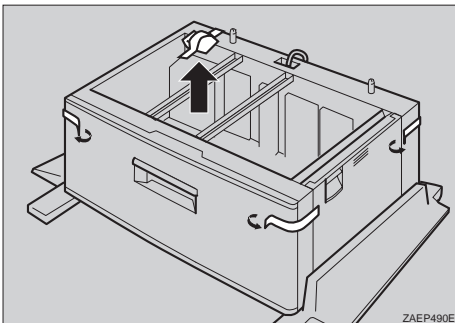

- 4** Slide out the four handles on both sides of the printer.

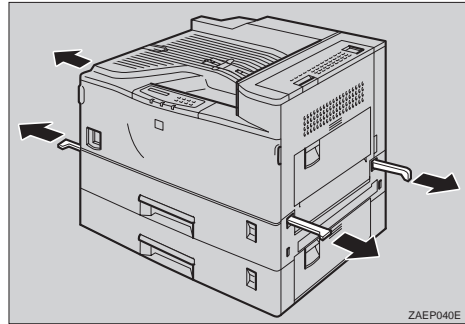

- 5** By holding the handles, align the front face of the printer and the paper feed unit, then place the printer on the paper feed unit.

Important

- When lifting the printer, pull out the grips from the front side of the printer. Hold the grips of the front side, and hold the inset grips of the rear side. The printer should be held by at least two people.

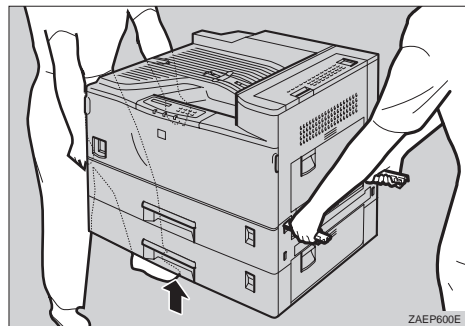

- Do not pinch the harness on the back of the paper feed unit and the printer.

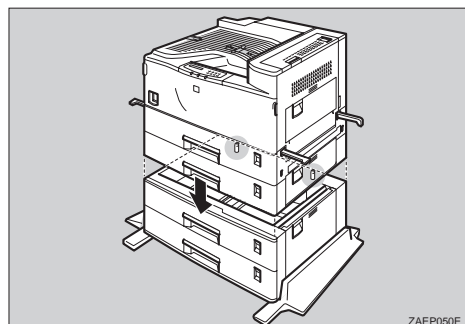

6 Return the handles that were pulled out in step 4, to their original position.

7 Slide tray 2 out until it stops. After that, lift the front, and pull it out.

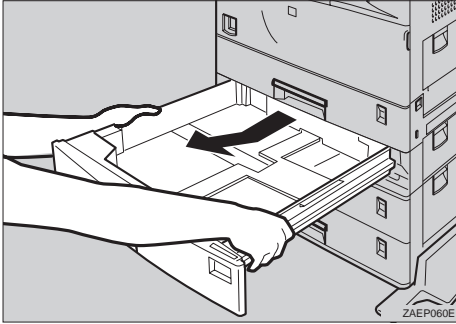

8 Use a coin to fasten the two screws that join the paper feed unit and the printer.

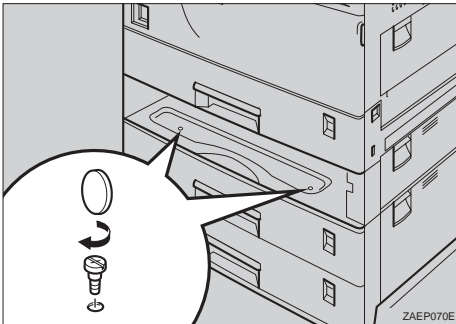

9 Return tray 2.

10 Attach the two securing brackets on the back of the printer and the paper feed unit, and fasten their screws using a coin.

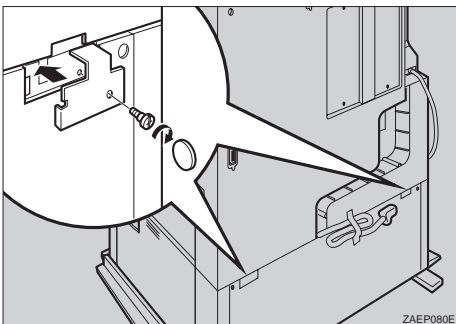

11 Remove the adhesive tape holding the cable and connect the harness on the back of the printer.

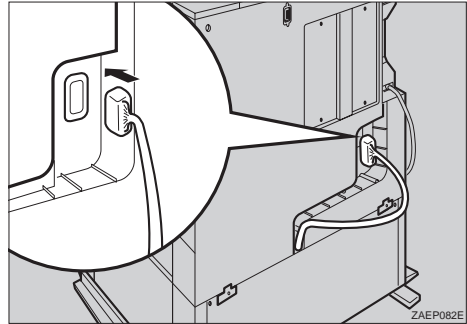

12 Push the cable of the connected harness into the groove for the cable until it stops.

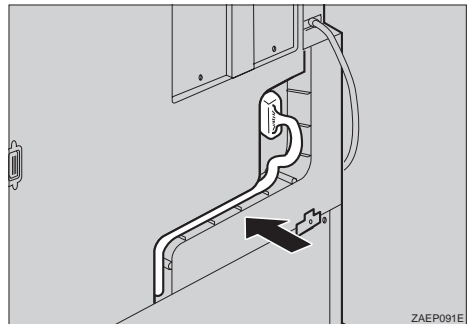

13 Attach cover 1 (1) and secure cover 1 to the printer fastening the screw (2).

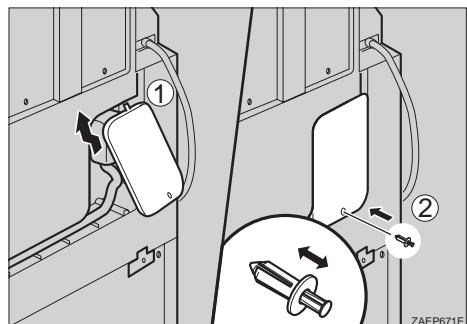

Note

- Insert the screw into the screw hole after confirming its inserting side is pulled out from the receiving side as shown in the illustration.

- 14** Attach cover 2 and secure cover 2 to the printer inserting the two screws.

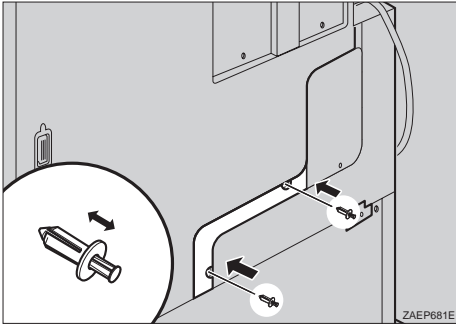

- 15** Turn the adjuster at the center bottom of the paper feed unit clockwise until it touches the floor.

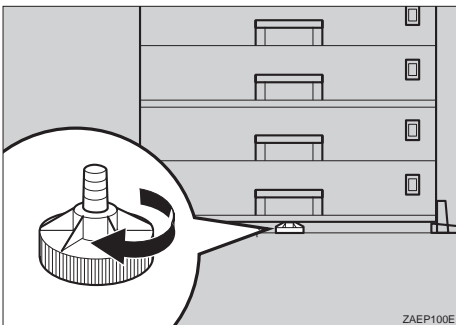

Note

- If PS400 is installed, this procedure is not necessary.

- 16** Put the paper size seal directly below the paper size display of the front on the paper feed tray.

Note

- Use the paper size seal included with the printer.
- After installed the last option that you want, print a configuration page to confirm the installation. If the new device is listed in the column of configuration options, then it has been properly installed. For more information on printing a configuration page, see P.37 "Printing a Configuration Page".

Installing Interchange Unit Type 280

- 1** Confirm that the box contains the following items.
- Installation Guide
- 2** Turn off the printer, and remove all cables and cords from the printer.
- 3** Remove the adhesive tape and the packing materials.

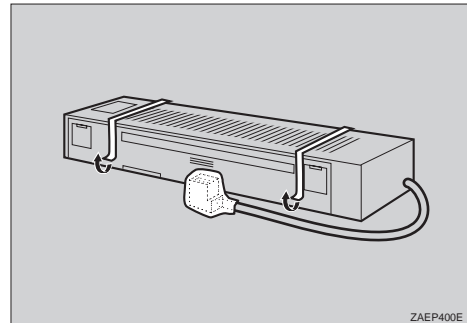

- 4** Open the right cover of the printer by lifting the catch.

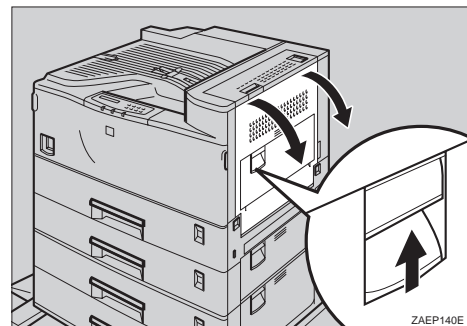

1

5 Open the upper right cover by lifting the handle.

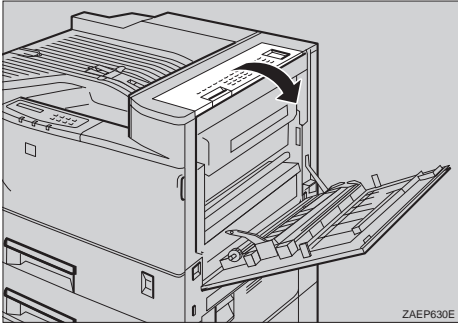

6 Press the upper right cover in the direction as shown in the illustration (①), and remove the upper right cover (②).

Note

The upper right cover is no longer required.

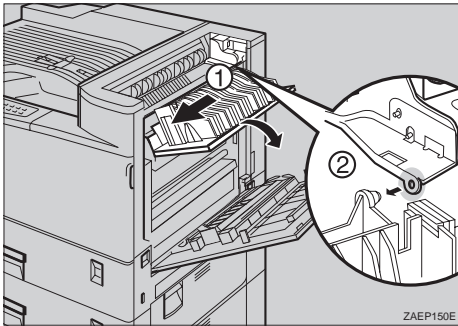

7 Use a coin to remove the screw from the upper cover of the printer.

Note

The removed screw is no longer required.

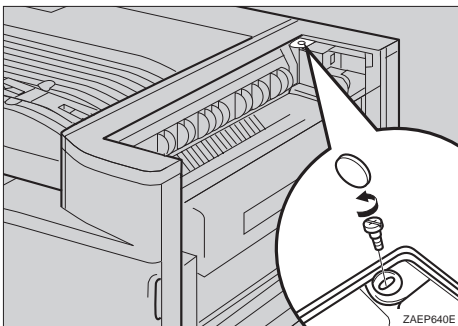

8 Put your fingers inside the upper cover of the printer and remove the cover by pulling upward.

Note

The upper cover of the printer is no longer required.

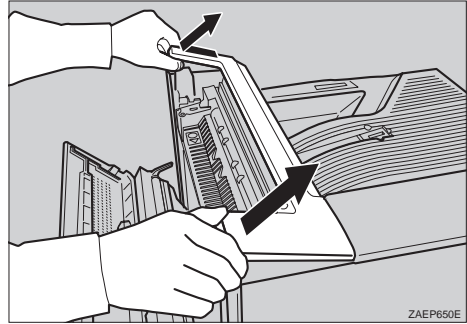

9 Remove the interchange unit cover from the interchange unit.

Note

The removed cover is required in step 10.

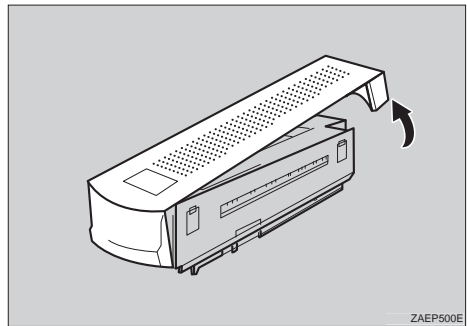

10 Move the cable to the back of the printer. Place the interchange unit onto the printer as shown in the illustration.

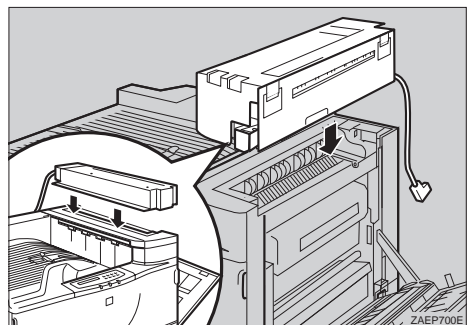

- 11** Open the upper right cover (①) and slide the interchange unit while keeping the cover perpendicular to the printer (②). At this time, confirm that the projection (③) is placed in the hole securely as shown in the illustration.

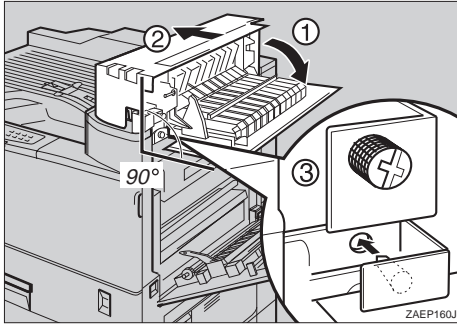

- 12** Fasten the two screws with fingers, while keeping the upper right cover of the interchange unit perpendicular to the printer, and secure the interchange unit to the printer. Use a coin to fasten the screws.

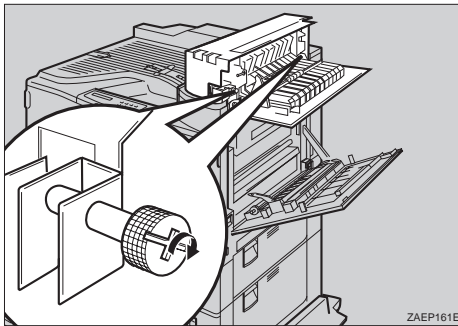

- 13** Close the upper right cover of the interchange unit.

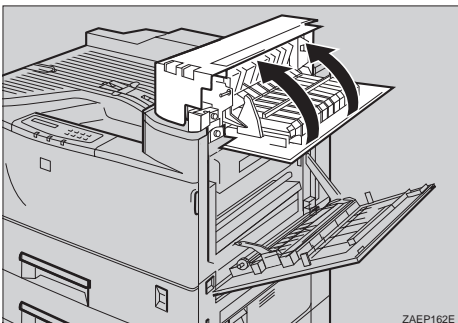

- 14** Close the right cover by pushing the area as shown in the illustration.

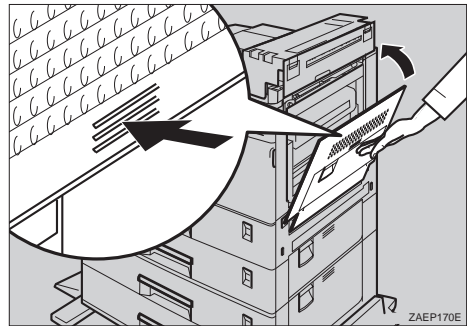

- 15** If the mailbox is not installed, attach the interchange unit cover that was removed in step 9. Attach the side of the cover facing the front of the printer first (①) and then the other side of the cover (②).

Note

- To attach the mailbox, go to step 16.

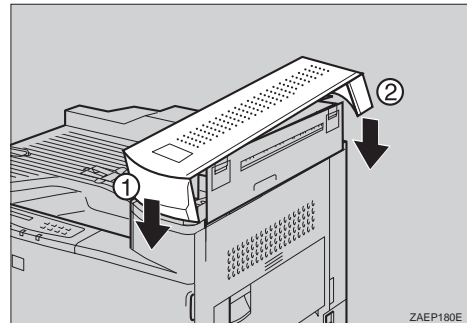

- 16** Attach the connector of the interchange unit to the socket on the back of the printer as shown in the illustration.

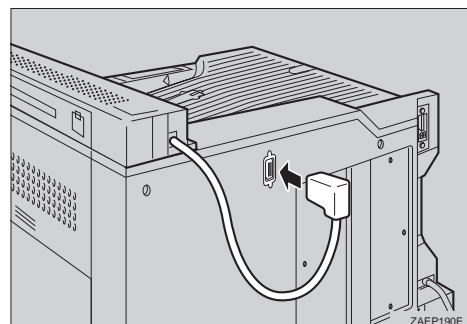

Installing AD370 (Duplex Unit)

1

Preparation

The installation procedure when the bypass tray unit is not yet installed is described below.

If the bypass tray unit is already installed, perform steps 8 to 10 of P.19 "Installing Bypass Tray Type 270". You can skip steps 5 to 7 below.

Important

- ❑ If you install the duplex unit, the interchange unit must be installed first.

- 1 Confirm that the box contains the following items.

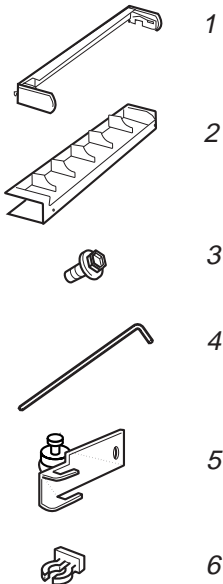

ZAEP382E

1. Holder
 2. Cover of the holder
 3. Socket screws (3 pcs)
 4. Wrench
 5. Hook
 6. Hook holder
- Installation Guide

- 2 Turn off the printer, and remove all cables and cords from the printer.

- 3 Remove the adhesive tape and the packing materials.

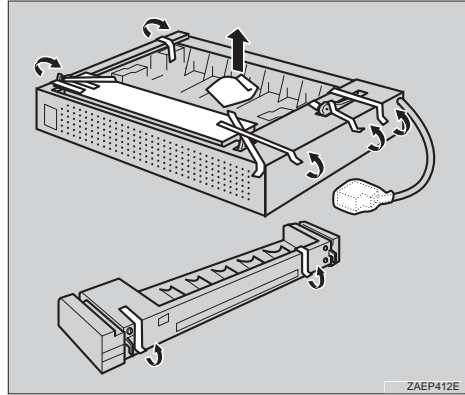

ZAEP412E

- 4 Remove the two small covers from the top right side of the printer.

Note

- ❑ The removed small covers are no longer required.

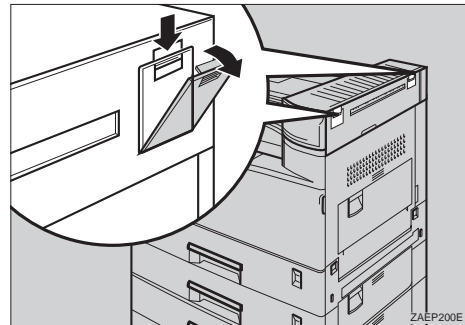

ZAEP200E

- 5** Use a coin to remove the two screws on the right side of the printer.

 **Note**

- The removed screws are no longer required.

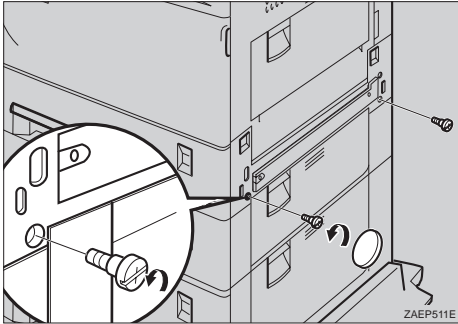

- 6** Use the wrench to remove the two socket screws from the cover on the right side of the printer, and remove the cover.

 **Note**

- The removed screws and cover are no longer required.

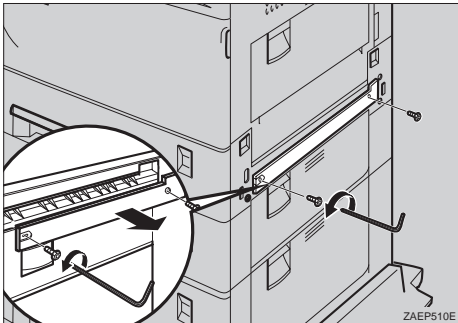

- 7** Mount the brackets of the holder by placing them in the printer and pushing downwards slightly.

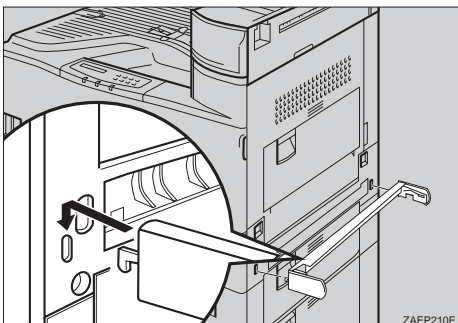

- 8** Use the wrench to fasten the four socket screws in the order as shown in the illustration (① - ④), to secure the holder to the printer.

 **Important**

- The order to fasten the screws is, top right, top left, bottom right and bottom left as viewed from the right side of the printer. If the screws were not fastened in that order, the duplex unit might not close completely or the bypass tray might not work correctly.

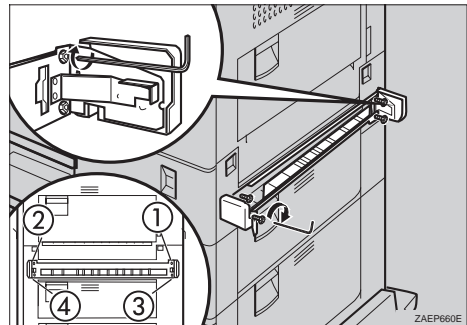

- 9** Remove the small cover on the right side of the printer.

 **Note**

- The removed small cover is no longer required.

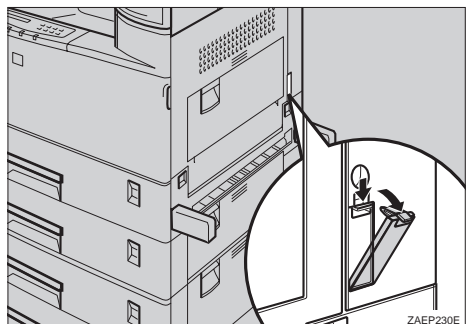

10 Mount the brackets in the holes inside of the cover that was opened in step 9. Use the wrench to fasten the socket screw, to secure the hook to the printer.

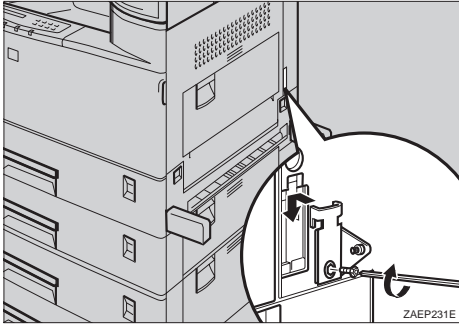

11 Lower the duplex unit so that the groove in each arm of the unit forms a joint with the pin inside the holder as shown in the illustration.

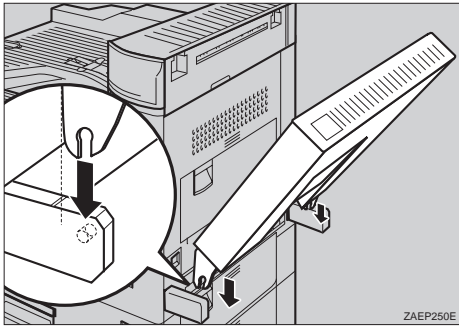

12 Hang the support bar in the duplex unit on to the hook that was attached in step 10 (1), and secure the bar by attaching the holder to the joint (2).

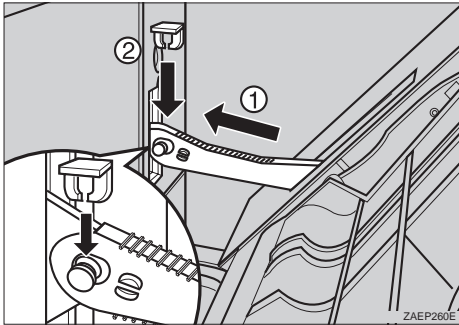

13 Close the duplex unit.

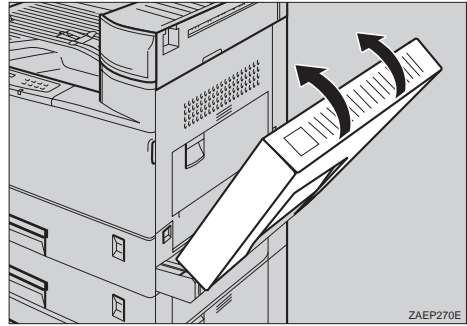

Note

- If the duplex unit is not closed completely, the holder was not installed properly in step 8. Fasten the socket screws securely in the order described in step 8.

14 Attach the connector of the duplex unit to the socket.

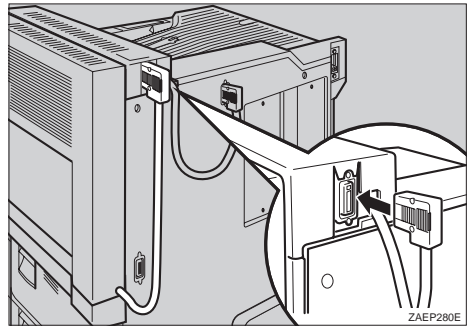

15 If the bypass tray is not attached, attach the cover of the holder. Use the wrench to fasten the two socket screws in the order as shown in the illustration to secure the holder to the cover.

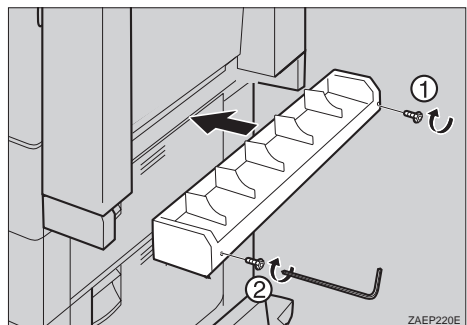

Note

- When attaching the bypass tray, the cover of the holder is not required.
- Keep the wrench in the wrench house inside of the front cover.

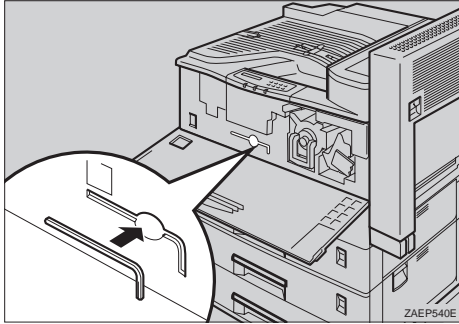

- After installed the last option that you want, print a configuration page to confirm the installation. If the new device is listed in the column of configuration options, then it has been properly installed. For more information on printing a configuration page, see P.37 "Printing a Configuration Page".

Installing Bypass Tray Type 270

Preparation

The installation procedure for installing the bypass tray when the duplex unit is not yet installed is described below.

If the duplex unit is already installed, remove the holder cover.

Note

- If you install the duplex unit and the bypass tray unit, the duplex unit must be installed first.
- If the duplex unit is already installed, perform steps 1 to 3 and then go to step 9.

1 Confirm that the box contains the following items.

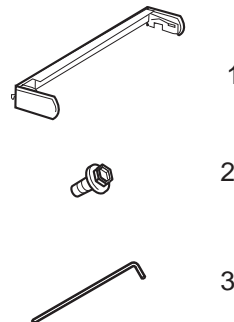

ZAEP430E

1. Holder
2. Socket screws (2 pcs)
3. Wrench
 - Installation Guide

Note

- If the duplex unit is already installed, the holder is no longer required. Go to step 8.

2 Turn off the printer, and remove all cables and cords from the printer.

3 Remove the adhesive tape and the packing materials.

Important

- Don't remove the adhesive tape (①) that is holding the tray and cable, until the bypass tray is attached in step ⑩.

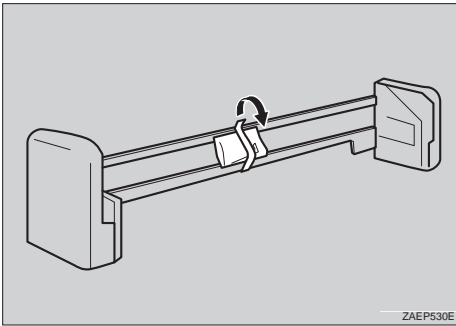
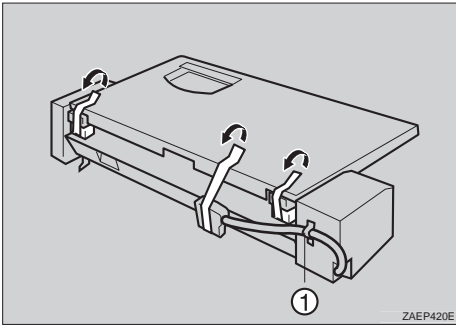

4 Use a coin to remove the two screws of the right side of the printer.

Note

- The removed small covers are no longer required.

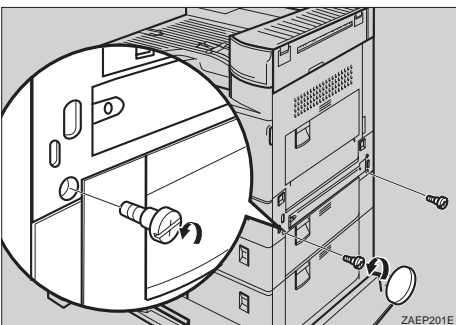

5 Remove the two socket screws holding the cover on the right side of the printer using the included wrench, and remove the cover.

Note

- The two removed socket screws and the detached cover are no longer required.

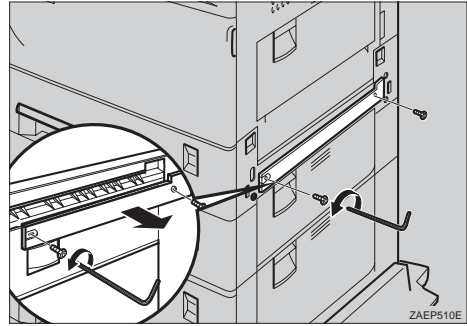

6 Mount the brackets of the holder by placing them in the printer and pushing downwards slightly.

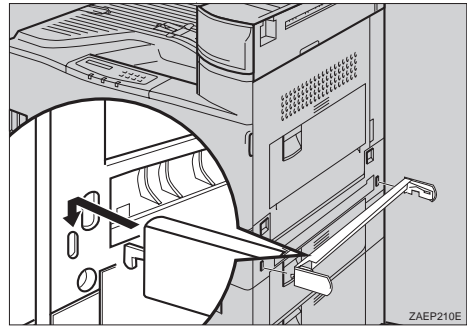

7 Use the wrench to fasten the four socket screws in the order shown in the illustration (① - ④), to secure the holder to the printer.

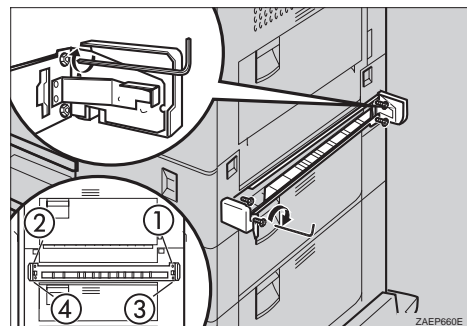

Important

- ❑ The order to fasten the screws is, top right, top left, bottom right and bottom left as viewed from the right side of the printer. If the screws were not fastened in that order, the duplex unit might not close completely or the bypass tray might not work correctly.

- 8** If the duplex unit is not installed, skip this step, and go to step **9**. If the duplex unit is installed, the plastic edges on each side of the unit must be removed. The edges are held in place by four small posts. Twist the edges to break the posts and remove them from the unit.

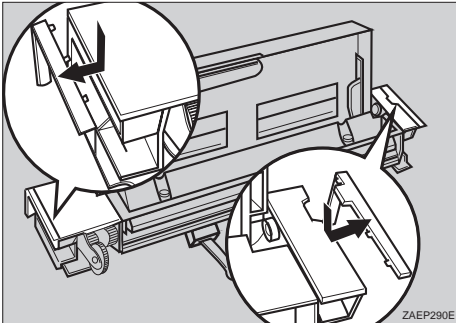

- 9** Slide the bypass tray into the printer aligning the grooves of the right and left sides of the bypass tray onto the rails inside the holder.

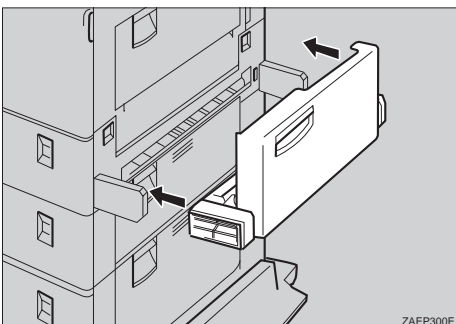

- 10** Use the wrench to attach the bypass tray to the holder. Fasten the screws in the order shown in the illustration.

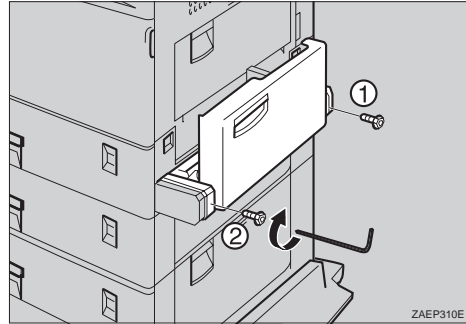

- 11** Remove the adhesive tape holding the bypass tray and cable, and attach the connector to the socket on the left bottom side of the back of the printer.

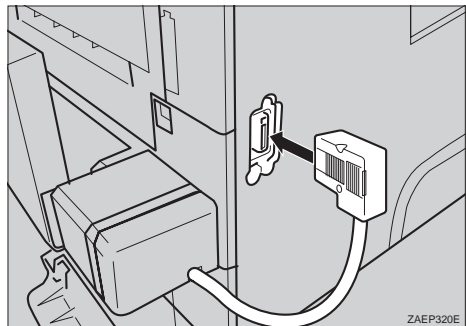

Note

- ❑ Keep the wrench in the wrench house inside of the front cover. Only one wrench can be kept in the wrench house.

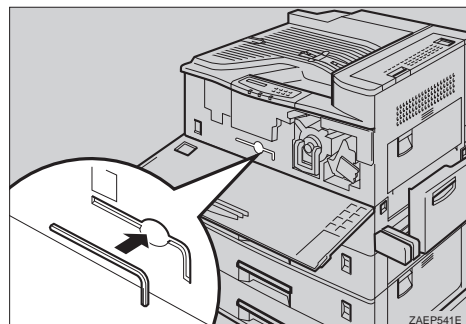

- ❑ After installed the last option that you want, print a configuration page to confirm the installation. If the new device is listed in the column of configuration options, then it has been properly installed. For more information on printing a configuration page, see P.37 "Printing a Configuration Page".

Installing CS370 (Mailbox)

⚠ CAUTION:

- When lifting the machine, use the grips on both sides. The machine could break or cause an injury if dropped.

📌 Note

- ❑ If you install the mailbox, the interchange unit must be installed first.
- ❑ If you install the mailbox and the paper feed unit, the paper feed unit is recommended to be installed first.

- 1** Confirm that the box contains the following items.

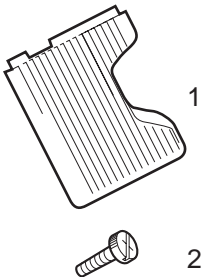

ZAEP383E

1. Mailbox output trays (4 pcs)

2. Screws (2 pcs)

- Installation Guide
- Output tray number seal

- 2** Turn off the printer, and remove all cables and cords from the printer.

- 3** Remove the adhesive tape.

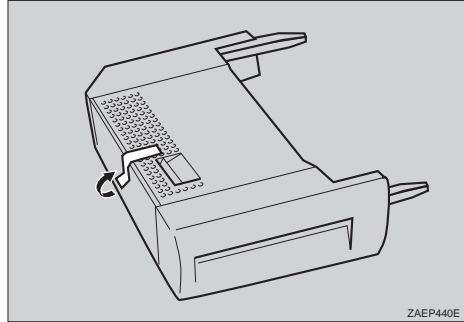

- 4** If you installed the duplex unit, open the duplex unit by lifting the catch.

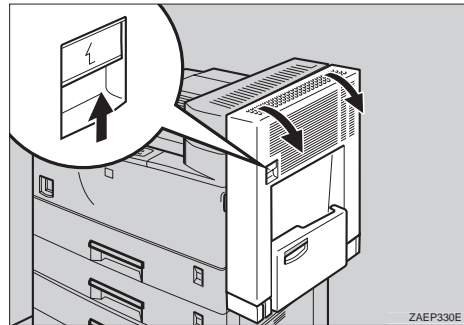

- 5** Open the right cover by lifting the catch.

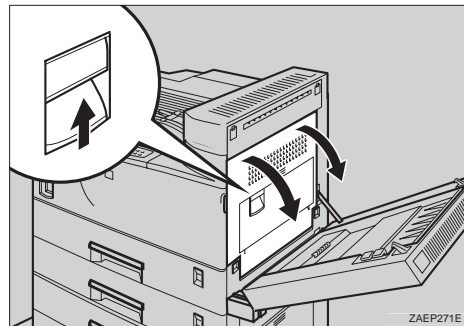

- 6** If the cover of the interchange unit is attached, remove it by sliding it out toward the back of the printer.

 **Note**

- If the cover of the interchange unit is already removed, go to step **7**.
- The removed cover is no longer required.

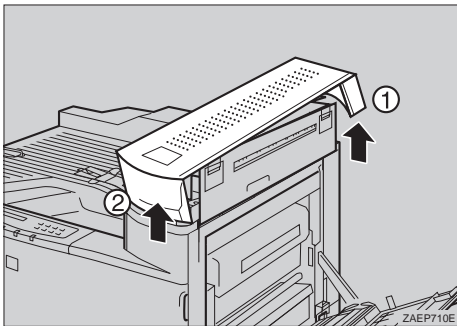

- 7** Hold the mailbox on both sides and insert it into the printer from the top side of the printer.

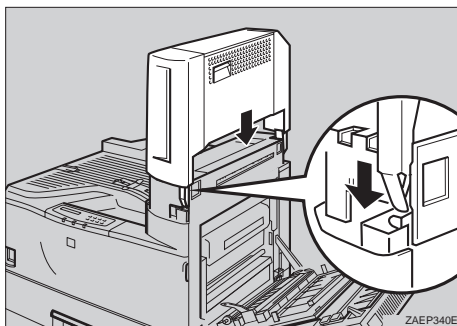

- 8** Fasten the two screws by hand and secure the mailbox to the printer. Use a coin to fasten the screws securely.

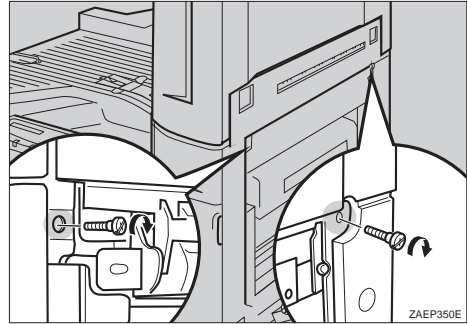

- 9** Close the right cover by pushing the area as shown in the illustration.

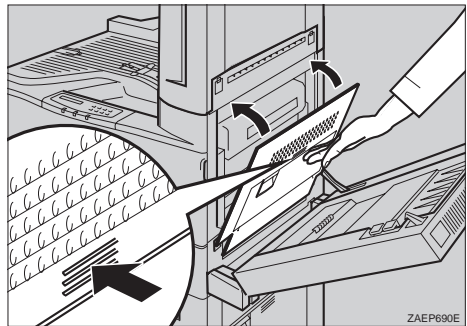

- 10** If the duplex unit is already attached, close the unit.

- 11** Slide the four mailbox output trays into the lower side of the mailbox first.

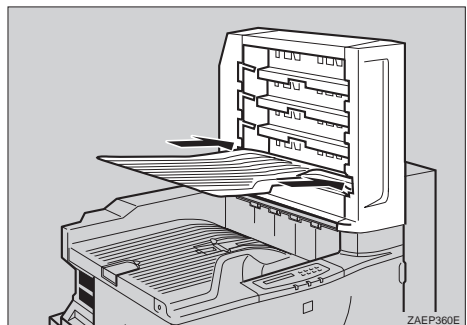

 **Note**

- ❑ After installed the last option that you want, print a configuration page to confirm the installation. If the new device is listed in the column of configuration options, then it has been properly installed. For more information on printing a configuration page, see P.37 "Printing a Configuration Page".

Installing Printer Feature Expander Type 185

 **Important**

- ❑ The memory unit can be damaged by small amounts of static electricity. Before touching it, ground yourself by touching something metal to remove static electricity from you.

 **Note**

- ❑ If you install Printer Feature Expander Type 185 and Printer Hard Disk Type 185, Printer Feature Expander Type 185 must be installed first.

1 Confirm that the box contains the following item.

- Memory

2 Turn off the printer, and remove all cables and cords from the printer.

3 Use a coin to remove the six screws, and remove the printer board cover.

 **Note**

- ❑ The removed cover and screws are required in step **5**.

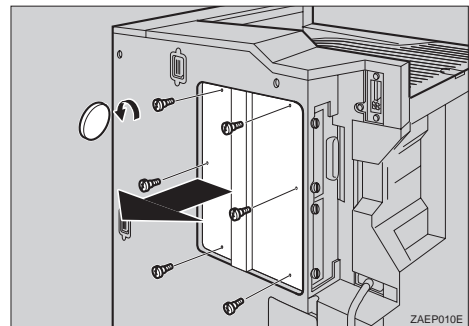

- 4** Tilt the memory unit so that it is 30 degrees perpendicular to the slot (①), and push it forward (②). It should make click into place.

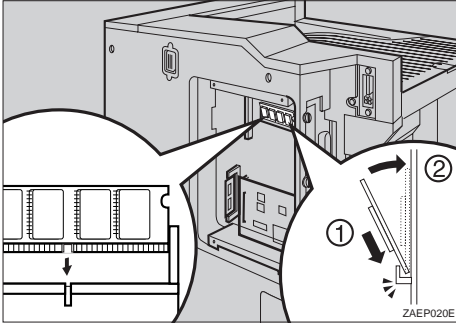

Note

- If the hard disk is already installed, remove the hard disk first.

- 5** Attach the printer board cover that was removed in step 3, and use a coin to fasten the six screws.

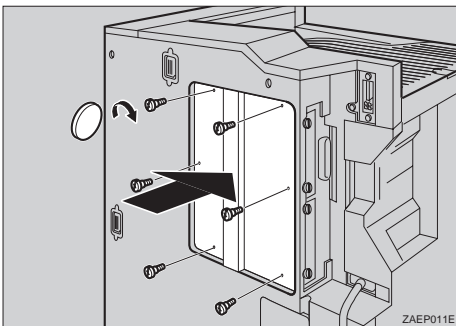

Note

- If you continue to install the hard disk, it is not necessary to reattach the cover.
- After installed the last option that you want, print a configuration page to confirm the installation. If the new device is listed in the column of configuration options, then it has been properly installed. For more information on printing a configuration page, see P.37 "Printing a Configuration Page".

Installing Printer Hard Disk Type 185

Important

- The hard disk can be damaged by small amounts of static electricity. Before touching it, ground yourself by touching something metal to remove static electricity from you.

- 1** Confirm that the box contains the following items.

- Hard disk
- Installation Guide

- 2** Turn off the printer, and remove all cables and cords from the printer.

- 3** Use a coin to remove the six screws, and remove the printer board cover.

Note

- The removed cover and screws are required in step 7.

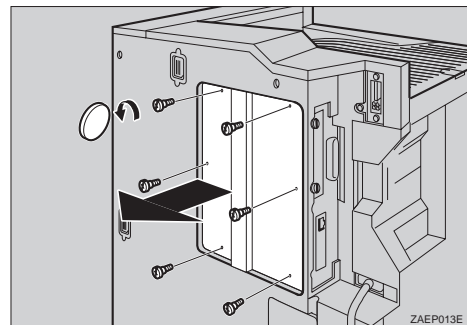

4 Use a coin to remove the two screws, and remove the cover.

Note

- The removed screws are required in step **6**.
- The removed cover is no longer required.

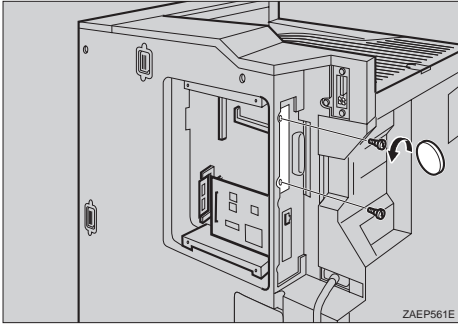

5 Align the hard disk interface connector over the printer interface port, and push gently but firmly on the hard disk until it is completely connected.

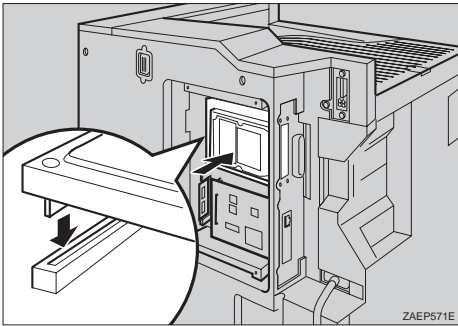

6 Fasten the two screws that were removed in step **4** to attach the hard disk to the printer.

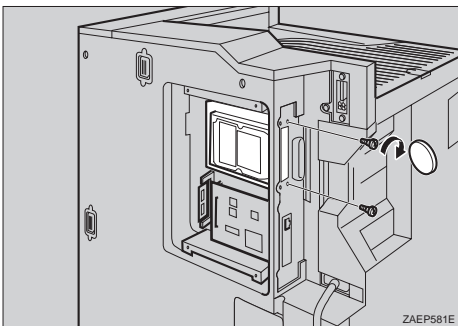

7 Attach the printer board cover that was removed in step **3**, and use a coin to fasten the six screws.

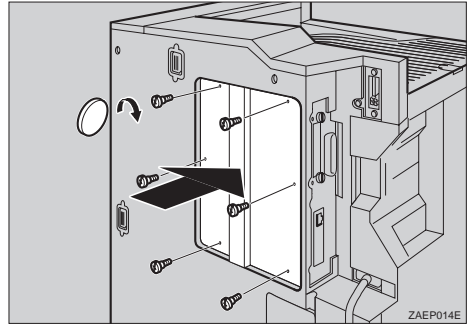

Note

- After installed the last option that you want, print a configuration page to confirm the installation. If the new device is listed in the column of configuration options, then it has been properly installed. For more information on printing a configuration page, see P.37 "Printing a Configuration Page".

Installing the Toner Bottle

⚠ WARNING:

- *Do not incinerate spilled toner or used toner. Toner dust is flammable and might ignite when exposed to an open flame.*
- *Disposal should take place at an authorized dealer or an appropriate collection site.*
- *If you dispose of the used toner containers yourself, dispose of them according to local regulations.*

⚠ CAUTION:

- *The inside of the machine becomes very hot. Do not touch the parts with a label indicating a "hot surface". Touching a "hot surface" could result in a burn injury.*
- *Do not eat or swallow toner.*
- *Keep toner (used or unused) and the toner cartridge out of reach of children.*
- *Our products are engineered to meet the highest standards of quality and functionality. When purchasing expendable supplies, we recommend using only those provided by an authorized dealer.*

1 Open the front cover.

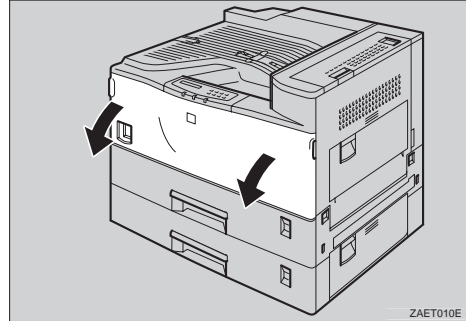

2 Lift the green handle.

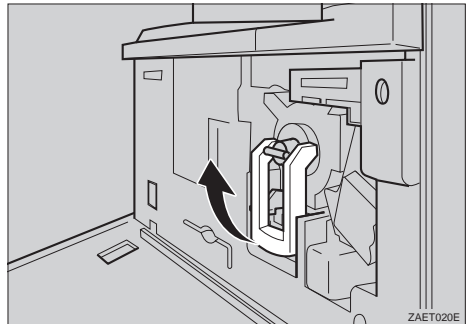

3 While pushing the green lever (1), hold the handle and slide the toner holder out slightly (2).

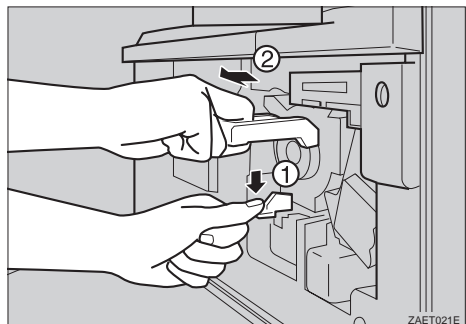

1

4 Release the green lever and slide the toner holder out until it stops gently.

Important

If you continue to push the green lever to slide the toner holder, the toner holder might drop.

5 Move the new toner bottle back and forth about 5 - 6 times (①), and remove the black cap of the new toner bottle by turning it counterclockwise (②).

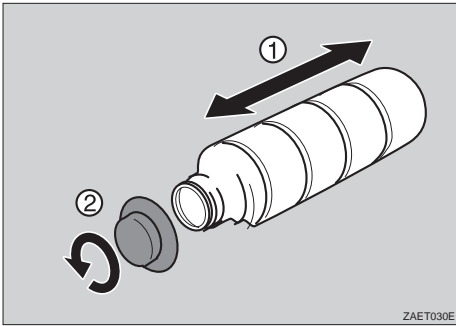

Important

Do not remove the inside cap.

Note

After removing the black cap from the bottle, toner can scatter easily. Do not shake or jar the bottle.

6 Put the toner bottle on the toner holder (①), then push its head downwards to lock it in place (②).

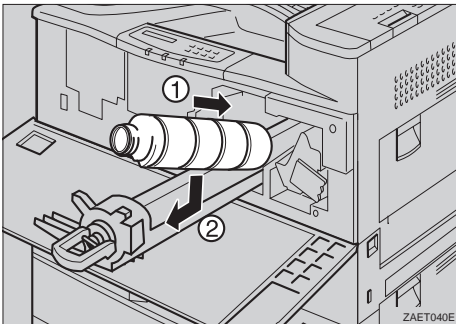

7 Slide the toner holder into the printer until it clicks into place, and push the green handle down.

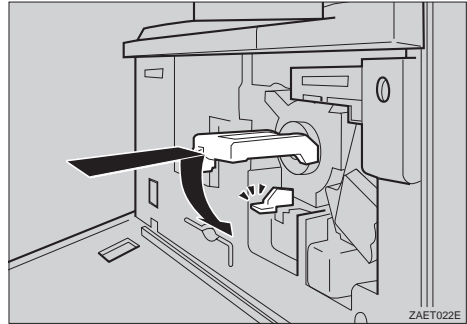

8 Close the front cover.

Loading Paper

This section describes the type, size, feed direction, and maximum capacity of paper that can be loaded into each paper tray in this printer.

Reference

For more information on the size and feed direction of paper that can be set in the tray, see "Paper Type and Sizes" in the "Printer Reference."

Loading Paper on the Paper Tray

This section describes instructions for loading paper in the standard paper tray and optional PS400 or PS440. If you want to load paper in PS420, see P.31 "Loading Paper on PS420 (Paper Feed Unit)". If you want to load paper in Bypass Tray Type 270, see P.32 "Loading Paper on Bypass Tray Type 270".

- 1** Slide the paper tray out until it stops.

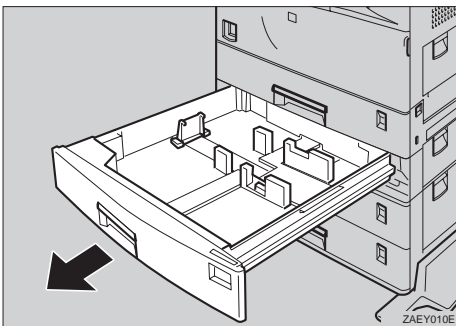

- 2** Set the paper guide lock to the "unlocked" position.

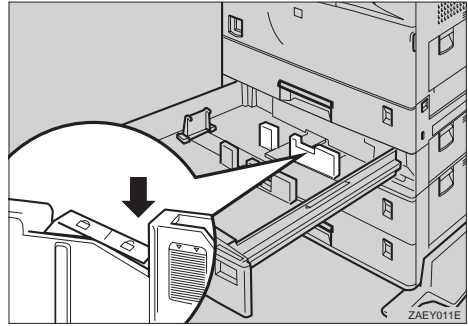

Important

- Confirm that the lever of the side guide is released before sliding this guide, otherwise it can be damaged.

- 3** Slide the side paper guide wide open (2) by pressing the release lever of the side guide (1).

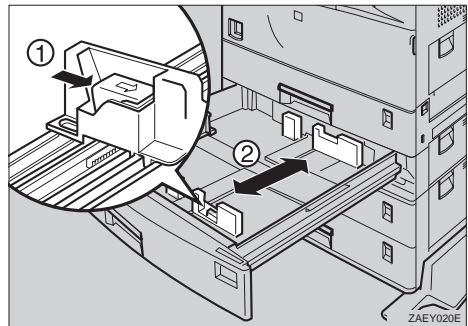

4 Align all four sides of the paper stack, and load it into the tray.

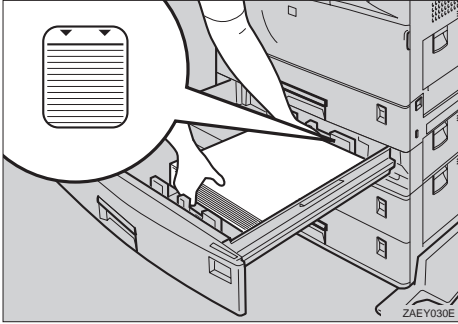

Important

- Do not stack paper over the limit mark.
- When you set thick paper in tray 2, do not stack paper above the lower limit mark (①) of tray 2.

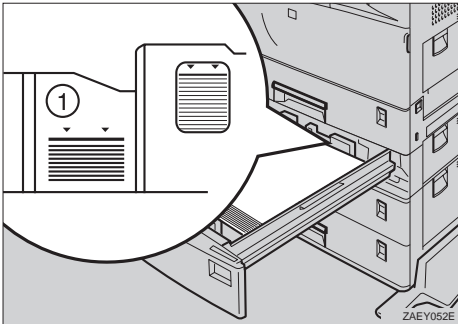

Note

- Shuffle the paper before setting in the tray.
- Load the paper face up onto the tray.

5 Align the side guide for the loaded paper size (②) by opening the release lever of the side guide (①).

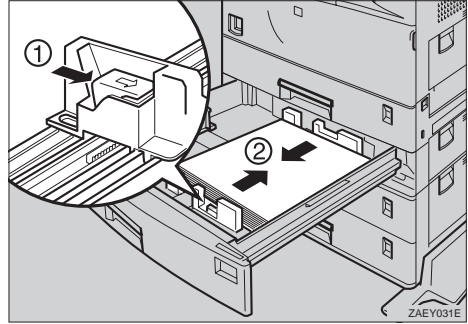

6 Set the paper guide lock to the "locked" position.

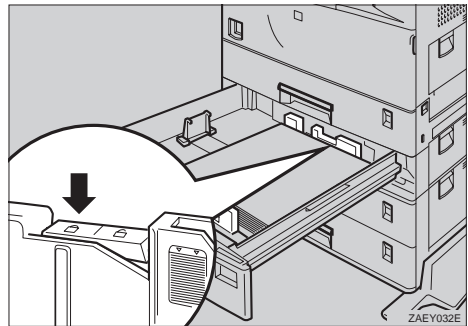

7 Align the rear guide for the loaded paper size slightly by pushing the releasing lever of the rear guide.

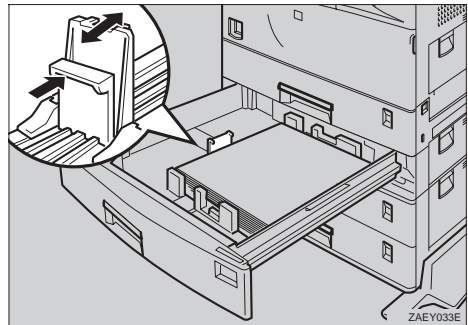

- 8** Adjust the paper size dial for loaded paper size.

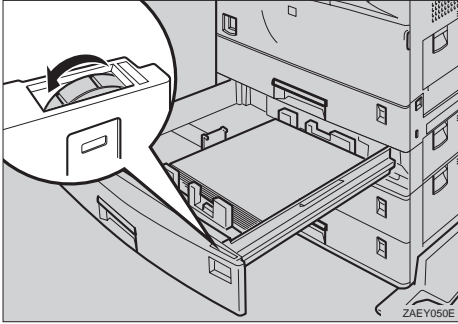

Important

- Confirm that the setting of the paper size dial matches the paper size and feed direction of the paper in the tray. Otherwise, the paper misfeed or unexpected printing result might occur.
- When the actual paper size is not shown on the dial, set the dial to "✖" and specify the paper size using the operation panel. For more information on setting up the paper size, see "Paper and Other Media" in the "Printer Reference".

Note

- Thick paper can be set in tray 2 of the printer or Bypass Tray Type 270. For more information on loading paper in the bypass tray, see P.32 "Loading Paper on Bypass Tray Type 270". When thick paper is placed on tray 2, change the lever on the paper size dial of tray 2 of the printer to the "Thick paper" mode. For more information on loading paper, see "Loading Thick Paper, Envelope or OHP Transparencies" in the "Printer Reference".

- 9** Slide the tray into the printer until it stops.

Loading Paper on PS420 (Paper Feed Unit)

Reference

For more information on the size and feed direction of paper that can be set in the tray, see "Paper Type and Sizes" in the "Printer Reference".

Note

- Load paper that is the same size on the right and left sides of the paper feed unit.

- 1** Slide the paper tray out until it stops.

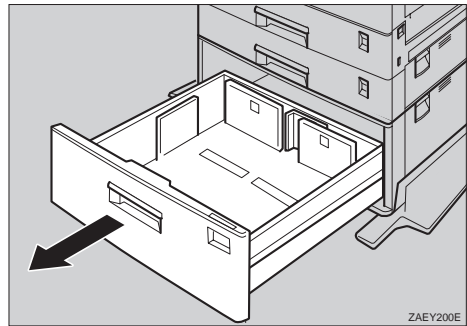

- 2** Load paper completely into the tray.

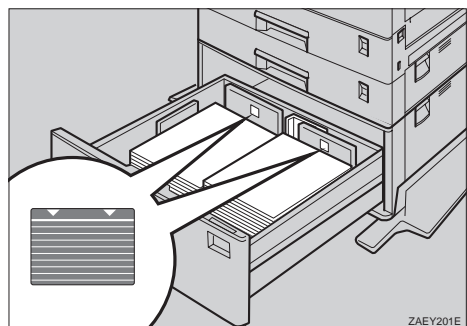

Important

- Align paper to each side completely.
- Do not stack paper over the limit mark.
- Confirm that the end fence locks completely after loading the right side paper.
- If you want to change the paper size, contact your sales or service representative.

Note

- Shuffle the paper before setting in the tray.
- Load the paper face up onto the tray.
- If either side or the leading edge of paper is curled, straighten it, and then load it.

- 3** Slide the tray into the printer until it stops.

Loading Paper on Bypass Tray Type 270

Note

- The supported size of the bypass tray is approximately 90 - 297 mm (3.54" - 11.69") in width, and approximately 148 - 432 mm (5.83" - 17.00") in length.
- To set the custom size with the operation panel, see "Specifying the Custom Paper Size for the Bypass Tray" in the "Printer Reference".
- If you load a custom or unique paper size, set the paper size using the operation panel.
- If thick paper, OHP transparencies or envelopes are loaded, set the printer to the "Thick paper" mode using the printer driver.

- 1** Open the bypass tray.

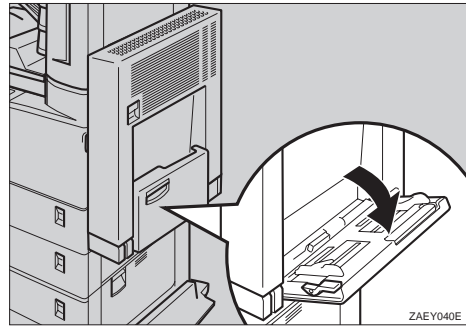

- 2** Lift the paper guide lever.

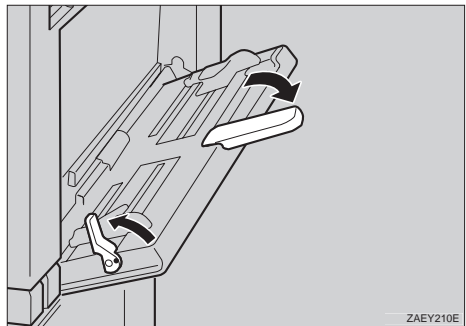

Important

- If the paper guides do not match the paper size, a skew image or a paper misfeed might occur.

Note

- Swing out the extender to support paper sizes longer than A4 short-edge feed (Metric version) or 8 1/2" x 11" short-edge feed (Inch version).

- 3** Load the paper, and adjust the paper guides to the sides of the paper.

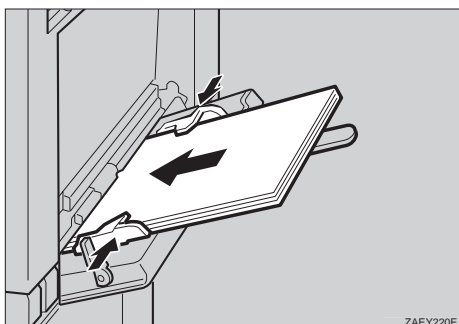

Important

- Confirm the print side of the OHP transparencies. Some OHP transparencies can be printed on only the specific side.

Note

- Do not stack paper over the limit mark. Otherwise a skew image or a paper misfeed might occur.
- Set the paper after shuffling through the sheets.
- Load the paper face down onto the tray.
- When you set custom size or thick paper in the bypass tray, do not stack paper above the lower limit mark of the bypass tray.

- 4** Push down the paper guide lever.

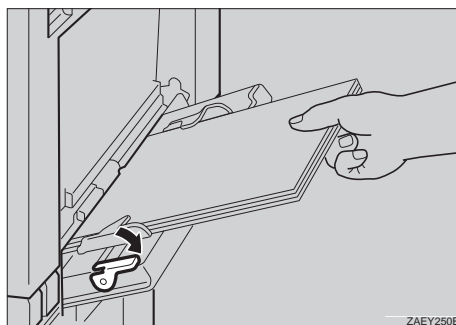

Note

- If the paper guide lever is not pushed down, paper misfeed might occur.

- 5** Turn on the printer.

Reference

For more information on turning on the printer, see P.35 "Connecting the Power Cord".

- 6** Configure the paper feed unit direction and the paper size.

Important

- The paper size specified with the printer driver overrides the one specified here.

Reference

For more information on specifying the bypass tray, see the printer driver help.

For more information on loading custom paper, see "Loading Paper and other Media" in the "Printer Reference".

- 1** Press **[Menu]**.

The following message appears on the panel display.

```
Main Menu:
Proof Print
```

- 2 Press **[▼]** or **[▲]** until the following message appears.

```
Main Menu:
Job Control
```

- 3 Press **[Enter]**.

The following message appears on the panel display.

```
Job Control:
Paper Input
```

- 4 Press **[Enter]**.

The following message appears on the panel display.

```
Paper Input:
Tray Priority
```

- 5 Press **[▼]** or **[▲]** until the following message appears.

```
Paper Input:
Bypass Size
```

- 6 Press **[Enter]**.

The following message appears on the panel display.

```
Bypass Size:
Standard Size
```

- 7 Press **[Enter]**.

The following message appears on the panel display.

```
Standard Size:
11 x 8 1/2
```

- 8 Press **[▼]** or **[▲]** to select the Standard size.

- 9 Press **[Enter]**.

The following message appears on the panel display.

```
Standard Size:
*8 x 13
```

 **Note**

- “~~*~~” shown in front of an item indicates that the item is currently selected.

- 10 After the panel display changes, press **[Menu]**.

The panel display returns to the ready condition as follows:

```
Ready
```

Connecting the Power Cord

⚠ CAUTION:

- Do not handle the plug with wet hands. Doing this might cause an electrical shock.

- 1** Confirm that the power is turned off. If it is on, turn it off.

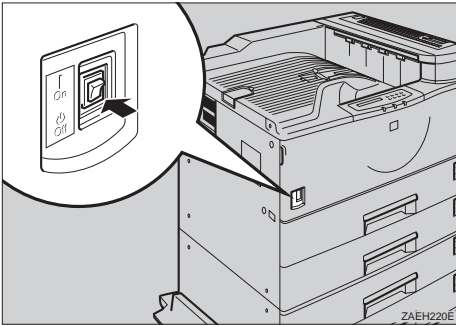

- 2** Insert the plug of the power cord securely into the printer.

- 3** Insert the plug of the power cord securely into the wall outlet.

⚡ Important

- Confirm that the printer is turned off when you insert or pull the plug of the power cord.

- 4** Turn on the printer.

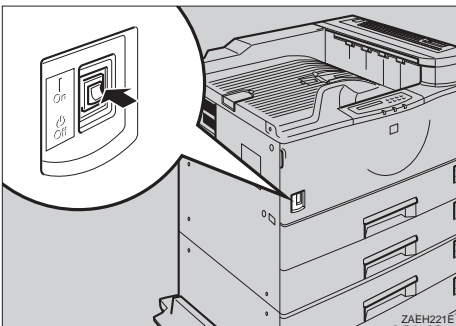

Selecting the Panel Display Language

1

 **Note**

- You can select one of the following languages: English, German, French, Italian, Dutch, Swedish, Norwegian, Danish, Spanish, Finnish, Portuguese, Czech, Polish, or Hungarian.
- The default setting is English.
- If you want to use the English panel display, it is not necessary for you to do the following procedures.

1 Press **[Menu]**.

The following message appears on the panel display.

```
Main Menu:
Proof Print
```

2 Press **[▼]** or **[▲]** until the following message appears.

```
Main Menu:
Language
```

3 Press **[Enter]**.

The following message appears on the panel display.

```
Language:
*English
```

 **Note**

- “*” shown in front of an item indicates that the item is currently selected.

4 Press **[▼]** or **[▲]** to display the language you want to select.

```
Language:
French
```

5 Press **[Enter]**.

The following message is displayed on the panel display for two seconds, and then the panel display automatically returns to the main menu.

```
Language:
*French
```

Printing a Configuration Page

You can confirm that the current configuration of the printer by printing a configuration page.

Reference

For more information on the items of a configuration page, see P.38 "Interpreting a Configuration Page".

1 Press **[Menu]**.

The following message appears on the panel display.

```
Main Menu:
Proof Print
```

2 Press **[▼]** or **[▲]** until the following message appears on the panel display.

```
Main Menu:
List Print
```

3 Press **[Enter]**.

The following message appears on the panel display.

```
List Print:
Config. Page
```

4 Press **[Enter]**.

The following message appears on the panel display.

```
Config. Page:
Press Enter (#)
```

5 Press **[Enter]**.

In a short time, the printing a configuration page will start.

Important

- If you cannot complete the printing a configuration page correctly, check if an error message appears on the panel display. For more information on error messages, see "Error & Status Messages on the Operation Panel" in the "Printer Reference."

Interpreting a Configuration Page

1

Reference

❖ Printer ID

Shows the serial number of the printer.

❖ Firmware Version

Shows the version number of the printer firmware.

❖ Pages Printed

Shows the total number of pages printed.

Memory

❖ Total Memory

Shows the total amount of memory installed on the printer.

❖ Proof Print Total Memory

Shows the total amount of hard disk space that is available for proof print jobs.

❖ Proof Print Free Memory

Shows the amount of hard disk space that is available for proof print jobs.

❖ Font Download Total Memory

Shows the total memory used by the downloaded fonts.

❖ Font Download Free Memory

- Total Memory
Shows the amount of memory that is available for font downloads.
 - Free Memory
Shows the amount of hard disk space that is available for font downloads.
-

Options

Shows the options installed on the printer.

Job Control

Shows the settings you make with the “Job Control” menu.

Reference

For more information on the “Job Control”, see “Job Control Menu” in the “Printer Reference”.

Network Setup

Shows the settings you make with the “Network Setup” menu and your computer.

Reference

For more information on the “Network Setup”, see “Network Setup” in the “Printer Reference”.

Maintenance

Shows the settings you make with the “Maintenance” menu.

Reference

For more information on the “Maintenance”, see “Maintenance Menu” in the “Printer Reference”.

Language

Shows the settings you select with the “Language” menu.

Reference

For more information on the “Language”, see “Language” in the Printer Reference.

Connecting the Printer

1

Requirements

Requirements

Before using this printer, confirm that all the environmental and electrical requirements have been met. Connect the printer to your host computer using the parallel port, 10BASE-T/100BASE-TX port, or both.

Confirm that all the cables, connectors, and electrical outlets necessary to attach the printer to your host computer or network are present.

Important

- The interface cable is not supplied in the box. It is your responsibility to provide the interface cable appropriate for the computer that you are using.
- It comes standard with network-ready Ethernet capability (Network Interface Board 185).

Reference

For more information on using the parallel port, see P.44 *“Connecting the Printer to the Host Using a Parallel Cable”*.

For more information on using a network, see P.42 *“Connecting the Printer to the Network”*.

Network Cable Requirements

Network Interface Board supports 10BASE-T or 100BASE-TX connections.

You can use the printer in the following network environments:

- Use the appropriate network management software and printer driver.
- Attach the printer to a networked computer set up as a server.

Client	Windows 95, 98, NT 4.0 *1, 3.1x, Macintosh
Driver	PCL 6/5e, PostScript 3
File Server	NetWare 3.x, NetWare 4.x, NetWare 5
Protocol	TCP/IP, IPX/SPX, NetBEUI *2, AppleTalk

*1 With Windows NT 4.0, only x86 based computers are supported.

*2 Under the Windows 95/98/NT 4.0 only.

In a mixed network environment, the protocol switches automatically.

Reference

For more information on configuring the Network Interface Board 185, see the "Operating Instructions" that comes with it.

For more information on resolving network connection problems, see "Troubleshooting" in the "Printer Reference".

Note

- Consult your network administrator before connecting your printer to a network.
- In a 100BASE-TX environment, be sure to use properly shielded and grounded cable (STP, Category/Type5) for the connection to your host computer (and/or HUB) in order to meet FCC and EMC Directive 89/336/EEC emission guidelines.

Parallel Cable Requirements

Connect the printer to your host computer using a parallel port. A parallel cable to connect the printer to the host computer is not included with this printer.

The printer's parallel interface is a standard bi-directional interface. It requires a standard 36-pin parallel cable compliant with IEEE 1284 and a parallel port available on the host computer.

Note

- Do not use a parallel cable that is longer than 3 meters (10 feet).

Connecting the Printer to the Network

1

Connect the printer to the network using Network Interface Board 185 which is built in as standard.

Follow these steps to connect the printer.

- 1** Confirm that you have the correct cable.
- 2** Confirm that the printer is turned off.
- 3** Loop the network cable. The loop should be about 10cm (4") from the end of the cable on the end closest to the printer.
- 4** Attach the ferrite core to the loop.

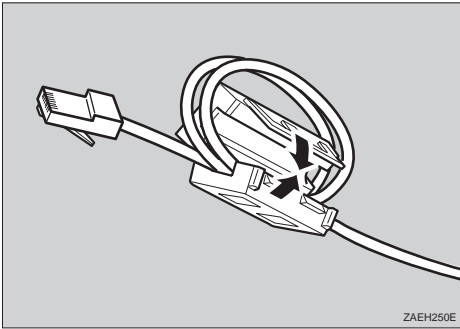

- 5** Attach the network cable to the 10BASE-T/100BASE-TX port of the printer.

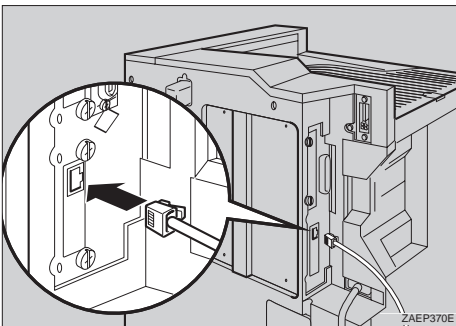

Reference

See "Guide to the Printer" in the "Printer Reference" to confirm the position of the 10BASE-T/100BASE-TX port.

Note

- Confirm that the cable is connected to the 10BASE-T/100BASE-TX port.

- 6** Connect the other end of the cable to the network.

Button and Indicators on the Network Interface Board

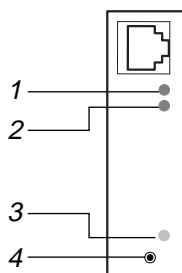

ZAEX010E

1. Indicator (green)

Stays on while the printer is in a network environment.

2. Indicator (green)

Stays on while 100BASE-TX is working.
Stays off while 10BASE-T is working.

3. Indicator (orange)

Stays on while the network interface board is working.

4. Button

Press this button for more than 2 seconds to print "Network Configuration Page".
Press this button for more than 5 seconds to print the "System Log Information".

Connecting the Printer to the Host Using a Parallel Cable

1

Connect the printer to the host computer using a parallel cable compliant with IEEE 1284.

Follow these steps to connect the printer to your host computer.

- 1** Confirm that you have the correct cable.
- 2** Confirm that both the printer and the host computer are turned off.
- 3** Plug the 36-pin end of the parallel cable into the parallel port of the printer.

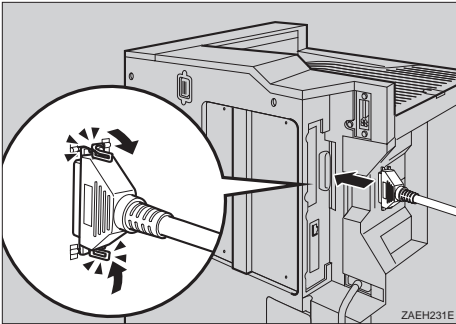

Reference

See "Guide to the Printer" in the "Printer Reference" to confirm the position of the parallel port.

- 4** Squeeze the wire clips on each side of the connector together until they snap into place. The clips hold the cable securely in place.
- 5** Plug the other end of the parallel cable into the computer's parallel port.

2. Configuring the Printer for the Network

Configuring the Printer for the Network with the Operation Panel

Reference

This printer contains Network Interface Board 185 as a standard. For more information on configuring for a network, see the "Operating Instructions" for the Network Interface Board which is included in the CD-ROM.

To use the network interface board, configure it for the network using the printer's operation panel.

The following table shows the operation panel settings and their default settings. These are included in the "Main Menu".

Items		Default
32	IP Address	011.022.033.044
33	Subnet Mask	000.000.000.000
34	Gateway Address	000.000.000.000
35	Access Control (Access Control Address)	000.000.000.000
36	Access Mask (Access Control Mask)	000.000.000.000
37	Network Boot	None
38	Frame Type(NW) (Frame Type NetWare)	Auto Select
39	ActiveProtocols	All Active

1 Press [Menu].

The following message appears on the panel display.

```
Main Menu:  
Proof Print
```

2 Press [▼] or [▲] until the following message appears.

```
Main Menu:  
Network Setup
```

3 Press [Enter].

The following message appears on the panel display.

```
Network Setup:  
IP Address
```

4 Use the following table to select the menu item appropriate for your network.

Menu item on the panel display	Active Protocol			
	TCP *1	NW *2	AT *3	NB *4
All Active (Default Setting)	✓	✓	✓	✓
None				
TCP/IP Only	✓			
NetWare Only		✓		
TCP/IP & NetW	✓	✓		
ATalk Only			✓	
TCP/IP & ATalk	✓		✓	
NetWare & ATalk		✓	✓	
TCP & NW & ATK	✓	✓	✓	
NetBEUI only				✓
TCP/IP & NB	✓			✓
NetBEUI & NetW		✓		✓
TCP & NB & NW	✓	✓		✓
NetBEUI & ATalk			✓	✓
TCP & NB & ATK	✓		✓	✓
NB & NW & ATalk		✓	✓	✓

- ✓ means that this protocol is active.
- Blank cell means that this protocol is not active.

*1 TCP/IP
 *2 NetWare
 *3 AppleTalk
 *4 NetBEUI

Note

You should not select protocols that are not used on your network.

1 Press [▼] or [▲] until the following message appears.

```

Network Setup:
ActiveProtocols
    
```

2 Press [Enter].

The following message appears on the panel display.

```

ActiveProtocols:
*All Active
    
```

Note

“✖” shown in front of an item indicates that the item is currently selected.

3 Press [▼] or [▲] until the protocols you want to use appears.

4 Press [Enter].

The actual procedure may differ depending on the protocol you use. Follow the appropriate procedure.

TCP/IP	5 ▶ 6 ▶ 7 ▶ 8 ▶ 10
NetWare	9 ▶ 10
AppleTalk	10
NetBEUI	10

5 If you use TCP/IP, you should assign the IP Address to your printer.

Note

- To get the IP Address for your printer, contact your network administrator.
- The IP Address is shown by Byte on the panel display.

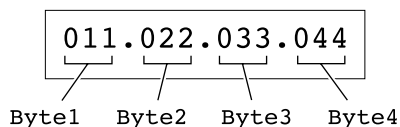

1 Press [▼] or [▲] until the following message appears.

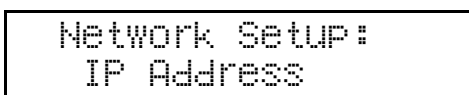

2 Press [Enter].

The current Byte 1 of the IP Address appears on the panel display.

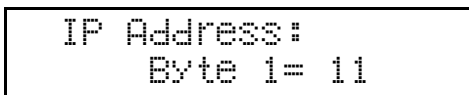

3 Use [▲] or [▼] to specify the IP Address.

4 Press [Enter].

The current Byte 2 of the IP Address appears.

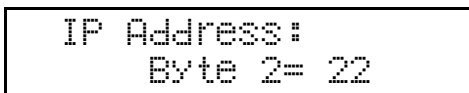

5 Use [▲] or [▼] to specify the Byte 2 of the IP Address.

Repeat steps **3** and **4** to specify the rest of the IP Address.

6 Press [Enter] to register the IP Address you specified.

6 If you use TCP/IP, you should assign the “Subnet Mask” and “Gateway Address” using the same procedure for specifying the IP Address.

7 If you use TCP/IP, set the “Access Control” and “Access Mask” using the same procedure for specifying the IP Address, if necessary.

8 If you use TCP/IP, you can make settings for “Network Boot”.

You can select how to assign the printer's address using the computer. Select one of the items on the following table.

Menu item on the panel display	Available method			
	AR *1	RA *2	BO *3	DH *4
ARP + PING	✓			
ARP & RARP	✓	✓		
ARP & BOOTP	✓		✓	
ARP&RARP&BOOTP	✓	✓	✓	
None (Default Setting)				
RARP + TFTP		✓		
BOOTP			✓	
RARP & BOOTP		✓	✓	
DHCP				✓

- *1 ARP + PING
- *2 RARP + TFTP
- *3 BOOTP
- *4 DHCP

Note

- You should set up your server, if you want to use “RARP + TFTP”, “BOOTP”, or “DHCP”.

1 Press [▼] or [▲] until the following message appears.

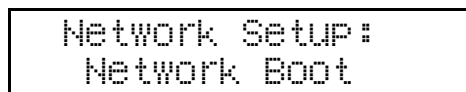

2 Press [Enter].

The current setting appears on the panel display.

```
Network Boot:
*None
```

3 Use [▼] or [▲] until the method you want to use appears.

4 Press [Enter].

9 If you use NetWare, select the frame type for NetWare.

Select one of the items below if necessary.

- Auto Select (Default)
- Ethernet 802.3
- Ethernet 802.2
- Ethernet II
- Ethernet SNAP

Note

Usually, you can use the default setting ("Auto Select"). With "Auto Select", the frame type detected by the printer first is adopted. If your network can use more than two frame types, the printer may fail to select the correct frame type. In this case, select the appropriate frame type.

1 Press [▼] or [▲] until the following message appears.

```
Network Setup:
Frame Type(NW)
```

2 Press [Enter].

The current setting appears on the panel display.

```
Network Setup:
*Auto Select
```

3 Use [▼] or [▲] until the frame type you want to use appears.

4 Press [Enter].

10 Exit from the setup menu to the available function settings.

1 Press [Escape].

2 Press [Escape].

3 Press [Exit].

11 If you want to confirm your printer's configuration, print a configuration page.

1 Press [Menu].

The following message appears on the panel display.

```
Main Menu:
Proof Print
```

2 Press [▼] or [▲] until the following message appears.

```
Main Menu:
List Print
```

3 Press [Enter].

The following message appears on the panel display.

```
List Print:
Config. Page
```

4 Press [Enter].

The following message appears on the panel display.

```
Config. Page:
Press Enter (#)
```

When printing a configuration page, you can confirm your printer's configuration.

 **Address**
❖ Subnet Mask

A number used to mathematically "mask" or hide an IP Address on the network by eliminating those parts of the address that are alike for all the printers on the network.

❖ Gateway Address

A gateway is a connection or interchange point that connects two networks. A gateway address is for the router or host computer used as a gateway.

 **Note**

- To get the addresses, contact your network administrator.

❖ Access Control Address and Access Control Mask

Access Control Address and Access Control Mask are used to control the IP Addresses that have access to the computer used for printing, with the IP Address. If it is not necessary for you to control the access rights, select "0.0.0.0".

 **Note**

- When the Access Control Address settings coincide with the masked result of the IP Address of the computer, print jobs from that IP Address can be accepted by the network interface board.
- For example, if you assign 192.168.15.16 as the Access Control Address to the network interface board, the combination of the Access Control Mask and IP Address that can have access are as follows. (xxx: for any numerical value)

Access Control Mask	IP Address that have access
0 . 0 . 0 . 0	xxx . xxx . xxx . xxx
255 . 0 . 0 . 0	192 . xxx . xxx . xxx
255 . 255 . 0 . 0	192 . 168 . xxx . xxx
255 . 255 . 255 . 0	192 . 168 . 15 . xxx
255 . 255 . 255 . 255	192 . 168 . 15 . 16

3. Installing the Printer Driver and Software

All of the procedures in this manual assume that you are familiar with general Windows procedures and practices. If you are not, see the documentation that comes with Windows for details.

Auto Run

You can install the printer driver by using Auto Run.

Auto Run is available for the following operating systems:

- Windows 95/98
- Windows NT 4.0

If your system is Windows 3.1x or Macintosh, see information on installing the printer driver.

⇒ P.55 *"Windows 95/98 - Installing the PCL 6/5e Printer Driver"*.

⇒ P.56 *"Windows 3.1x - Installing the PCL 6/5e Printer Driver"*.

⇒ P.62 *"Macintosh"*.

Important

- Before starting this installation, close all documents and applications. In a network environment, confirm that users who are logged on are disconnected. Be sure to do this when it will create the least interference with other users.
- After installing a printer driver, you must restart the computer.

Limitation

- If your system is Windows NT 4.0, installing a printer driver requires Full Control access permission. Members of the Administrators, Server Operators, Print Operators, and Power Users groups have Full Control permission by default. When you install a printer driver, log on under Full Control permission.

Reference

For more information on the software and utilities included on the CD-ROM, see P.53 *"Software and Utilities Included on the CD-ROM"*.

Note

- Auto Run might not automatically work with certain OS settings. In this case, start "SETUP.EXE" to install printer driver on the root.
- If you want to cancel Auto Run, insert the CD-ROM while pressing the **[SHIFT]** key until your computer finishes accessing the CD-ROM.

 **Using the Shared Printer on Windows NT 4.0 for Windows 95/98 Client**

If you want to share the printer on Windows NT 4.0, you must not install the printer driver using Auto Run. Install the printer driver of the Windows 95/98 for alternate driver.

For more information on installing the printer driver as an alternate driver, see P.55 “Windows NT 4.0 - Installing the PCL 6/5e Printer Driver”.

3

Installing by Auto Run

Follow these steps to install the printer driver on Windows 95/98/NT 4.0.

 **Important**

- Never have two versions of the same printer driver installed on your system at the same time. When upgrading to a new version of the printer driver, uninstall the old version, and then install the new one. For more information on uninstalling the printer driver and software, see “Uninstalling the Printer Driver and Software” in the Printer Reference.

 **Note**

- If the "plug and play" function is started by Auto Run, click **[Cancel]** of the **[New Hardware Found]** dialog box or **[Device Driver Wizard]**, and then insert the CD-ROM. **[New Hardware Found]** or **[Device Driver Wizard]** appears depending on the system version of the Windows 95/98.
- The appropriate language name is used in the CD-ROM folder: ENGLISH (English), DEUTSCH (German), FRANCAIS (French), ITALIANO (Italian), ESPANOL (Spanish), NEDRLNDS (Dutch), NORSK (Norwegian), DANSK (Danish), SVENSKA (Swedish), POLSKI (Polish), PORTUGUS (Portuguese), SUOMI (Finnish), MAGYAR (Hungarian), CESKY (Czechoslovakian)

- 1** Close all applications that are currently running.
- 2** Insert the CD-ROM in the CD-ROM drive.
- 3** Follow the instructions on the screen.
- 4** Restart your computer after installation is complete.
- 5** You should set up the options with the printer driver.

Software and Utilities Included on the CD-ROM

❖ Agfa Font Manager

Helps you to install new fonts, or organize and manage fonts already installed on your system.

❖ PRINTER MANAGER FOR ADMINISTRATOR

A utility for the system administrator to manage printers on the network.

Reference

For the name of the PRINTER MANAGER FOR ADMINISTRATOR you use, see the “Operating Instruction” for the Network Interface Board which is on the CD-ROM.

See the PRINTER MANAGER FOR ADMINISTRATOR Online Help for details on using the PRINTER MANAGER FOR ADMINISTRATOR.

❖ PRINTER MANAGER FOR CLIENT

A utility for users to manage their own print status on the network.

Reference

For the name of the PRINTER MANAGER FOR CLIENT you use, see the “Operating Instruction” for the Network Interface Board which is included in the CD-ROM.

See the PRINTER MANAGER FOR CLIENT Online Help for details on using the PRINTER MANAGER FOR CLIENT.

❖ Multidirect Print

A utility for printing on a “Peer-to-Peer” network.

Reference

For more information on Multidirect Print, see the “Operating Instructions” for the Network Interface Board which is included in the CD-ROM.

❖ PortNavi

A utility that helps you to use network printer effectively. It is useful in environments where two or more network printers are used.

Reference

For more information on PortNavi, see the “Supplement” for the Network Interface Board which is included in the CD-ROM.

❖ Acrobat Reader

A utility that allows you to read PDF (Portable Document Format).

 **Note**

- Documentation on using the printer is included on the CD-ROM in PDF format.

Installing the PCL 6/5e Printer Driver

Windows 95/98 - Installing the PCL 6/5e Printer Driver

Installing the Printer Driver

Install the driver in accordance with the steps explained. ⇒ P.52 “*Installing by Auto Run*”

Setting Up Options

Note

When setting up options, you should access the Printer Properties from Windows. You cannot access the Printer Properties from an application.

1 Click **[Start]** on the task bar, point to **[Settings]**, and then click **[Printers]**.

The **[Printers]** window appears.

2 Click the icon of the printer you want to use. On the **[File]** menu, click **[Properties]**.

3 Click the **[Accessories]** tab.

4 Select any options you have installed from the **[Options]** group.

5 Click **[OK]**.

Windows NT 4.0 - Installing the PCL 6/5e Printer Driver

Installing the Printer Driver

Install the driver in accordance with the steps explained. ⇒ P.55 “*Windows 95/98 - Installing the PCL 6/5e Printer Driver*”

If you want to share the printer on Windows NT 4.0, you must not install the printer driver using Auto Run. In this case, cancel Auto Run and install the printer driver using **[Add Printer Wizard]** in the **[Printers]** window.

When prompted for Windows NT 4.0 alternate driver location, specify the following folder in the CD-ROM.

- PCL 5e
 \DRIVERS\PCL5E\NT4\(\Lauguage)\DISK1\
- PCL 6
 \DRIVERS\PCL6\NT4\(\Lauguage)\DISK1\

When prompted for Windows 95/98 alternate driver location, specify the following folder in the CD-ROM.

- PCL 5e
 \DRIVERS\PCL5E\WIN95_98\(\Lauguage)\DISK1\
- PCL 6
 \DRIVERS\PCL6\WIN95_98\(\Lauguage)\DISK1\

Setting Up Options

Limitation

- Changing the setting of the printer requires Full Control access permission. Members of the Administrators, Server Operators, Print Operators, and Power Users groups have Full Control permission by default. When you set up options, log on under Full Control permission.

Note

- When setting up options, you should access the Printer Properties from Windows. You cannot access the Printer Properties from an application.

1 Click **[Start]** on the task bar, point to **[Settings]**, and then click **[Printers]**.

The **[Printers]** window appears.

2 Click the icon of the printer you want to use. On the **[File]** menu, click **[Properties]**.

3 Click the **[Accessories]** tab.

4 Select any options you have installed from the **[Options]** group.

5 Click **[OK]**.

Windows 3.1x - Installing the PCL 6/5e Printer Driver

Installing the Printer Driver

Important

- We recommend you to install the PCL 5e printer driver on your Windows 3.1x system. Under Windows 3.1x system, you might get some unexpected print results with the PCL 6 printer driver.

1 Close all the applications that are currently running.

2 Insert the CD-ROM in the CD-ROM drive.

3 From **[Program Manager]**, click **[Run]** on the **[File]** menu.

- 4** In the [Run] window, click [Browse].
- 5** Select the CD-ROM drive in the [Drives:] list.
- 6** Open [PCL5E] or [PCL6].
- 7** Open [WIN31].
- 8** Open the folder of the language you use.
- 9** Open [DISK1].
- 10** Double-click "SETUP.EXE".
- 11** Follow the instructions on the screen.

Setting Up Options

 **Note**

- When setting up options, you should access the Printer Setting dialog box from Windows. You cannot access the Printer Setting dialog box from an application.

- 1** From the [Main] group of [Program Manager], double-click [Control Panel].
- 2** Double-click the [Printers] icon.
- 3** In the [Installed Printers:] list, click the name of the printer you want to set up.
- 4** Click [Setup].
- 5** Click the [Accessories] tab.
The [Options] group appears.
- 6** Select any options you have installed from the [Options] group.
- 7** Click [OK] to close the Printer Setting dialog box.
- 8** Click [Close] to close the [Printers] dialog box.

Installing the PostScript Printer Driver

Windows 95/98 - Installing the PostScript Printer Driver

Installing the Printer Driver

Install the driver in accordance with the steps explained. ⇒ P.52 “*Installing by Auto Run*”

Setting Up Options

 **Note**

When setting up options, you should access the **[Device Options]** tab from Windows. You cannot set up options when accessing the **[Device Options]** tab from an application.

1 Click **[Start]** on the task bar, point to **[Settings]**, and then click **[Printers]**.

The **[Printers]** window appears.

2 Click the icon of the printer you want to use. On the **[File]** menu, click **[Properties]**.

3 Click the **[Device Options]** tab.

The **[Installable options]** group appears.

4 From the **[Installable options]** box, select the option you have installed.

The current setting is displayed in the **[Change settings for:]** list.

5 Use the **[Change setting for:]** list to select the appropriate setting for the selected option.

6 Click **[Apply]** to apply the settings you made.

7 After making all settings you want, click **[OK]**.

Windows NT 4.0 - Installing the PostScript Printer Driver

Installing the Printer Driver

Install the driver in accordance with the steps explained. ⇒ P.52 “*Installing by Auto Run*”

Setting Up Options

Limitation

- Changing the setting of the printer requires Full Control access permission. Members of the Administrators, Server Operators, Print Operators, and Power Users groups have Full Control permission by default. When you set up options, log on under Full Control permission.

Note

- When setting up options, you should access the Printer Properties from Windows. You cannot set up options when accessing the Printer Properties from an application.

1 Click **[Start]** on the task bar, point to **[Settings]**, and then click **[Printers]**.

The **[Printers]** window appears.

2 Click the icon of the printer you want to use. On the **[File]** menu, click **[Properties]**.

3 Click the **[Device Settings]** tab.

4 Use the **[Installable Options]** group to specify the options.

5 Click **[OK]** to close the Printer Properties.

Windows 3.1x - Installing the PostScript Printer Driver

Installing the Printer Driver

1 Close all the applications that are currently running.

2 Insert the CD-ROM in the CD-ROM drive.

3 From the **[Program Manager]**, click **[Run]** from the **[File]** menu.

4 In the **[Run]** window, click **[Browse]**.

5 Select the CD-ROM drive in the **[Drives:]** list.

6 Open **[PS]**.

7 Open **[WIN31]**.

8 Open the folder of the language you use.

9 Open **[DISK1]**.

10 Double-click "SETUP.EXE".

11 Follow the instructions on the screen.

Setting Up Options

- 1** From the [Main] group of [Program Manager], double-click [Control Panel].
- 2** Double-click the [Printers] icon.
- 3** In the [Installed Printers:] list, click the name of the printer you want to set up.
- 4** Click [Setup].
- 5** Click the [Features] tab.
The [Printer Features] group appears.
- 6** Use the [Printer Features] group to specify the options.
- 7** Click [OK] to close the Printer Setting dialog box.
- 8** Click [Close] to close the [Printers] dialog box.

Using Adobe PageMaker Version 6.0 or 6.5

If you use the printer under Windows 95/98/NT 4.0 with Adobe PageMaker, you need to copy the PPD file to the PageMaker folder.

The PPD file is the file with extension ".ppd". It is in the folder "\PS\WIN95_98\Language\DISK1\" on the CD-ROM.

The **[WIN95_98]** folder, inside the **[PS]** folder is for the Windows 95/98 operating system. Use the folder at this level that is appropriate for the operating system you are using.

The third folder, "(Language)" may be substituted by appropriate language name.

Copy this file to the PageMaker folder.

For the PageMaker 6.0 default installation, the folder is "C:\PM6\RSRC\PPD4", and for the PageMaker 6.5 default installation, the directory is "C:\PM65\RSRC\USENGLISH\PPD4". The "USENGLISH" may be different, depending on your language selection.

Reference

For more information on the language name, see P.52 *Installing by Auto Run*.

Macintosh

Macintosh - Installing the PostScript Printer Driver

It is necessary to install a printer driver and a PPD file to print from a Macintosh. Follow these steps to install a printer driver and a PPD file into a Macintosh using a system 7.1 or later operating system.

Important

- You cannot use LaserWriter 8.5.0 or later with Mac OS 8.1 or later until you do the following procedure. Copy the “PrintingLib” file from the **[Extensions]** folder in **[System Folder]** to your desktop before installing the PostScript printer driver. After installing the PostScript printer driver, drag the “PrintingLib” file from your desktop back into the **[Extensions]** folder.
- If you forgot to copy the “PrintingLib” file, please reinstall the Macintosh operating system again.

- 1** Insert the CD-ROM in the CD-ROM drive.
- 2** Double-click the CD-ROM icon.
- 3** Double-click the **[PS]** folder.
- 4** Double-click the folder of the language you use.
- 5** Open **[Disk1]** and double-click the installer icon.
- 6** Follow the instructions on the screen.
- 7** Move the “PrintingLib” file from your desktop back to **[Extensions]** in **[System Folder]**.
- 8** Double-click **[Extensions]**.
- 9** Double-click **[Printer Descriptions]**.
- 10** Double-click the CD-ROM icon on the desktop.
- 11** Double-click **[Disk1]** in the folder of the language you use.
- 12** Click and drag the PPD file into **[Printer Descriptions]**.
- 13** Click and drag the “Proof Print” file into **[Printer Descriptions]** in **[Extensions]** in **[System Folder]**.
- 14** Restart the Macintosh.

Setting Up the PPD File

Preparation

Confirm that the printer is connected to an AppleTalk network before performing the following procedure.

- 1** On the [Apple] menu, click [Chooser].
- 2** Click the [Adobe PS] icon.
- 3** In the [Select a PostScript Printer:] list, click the name of the printer you want to use.
- 4** Click [Create].
- 5** Click the printer you want to use, and then click [Select].

The PPD file is set up, and the [Adobe PS] icon appears at the left of the printer name in the list. Next, use the procedure on P.63 “Setting Up Options” to make the option settings, or close the [Chooser] dialog box.

Setting Up Options

- 1** On the [Apple] menu, select [Chooser].
- 2** Click the [Adobe PS] icon.
- 3** In the [Select the PostScript Printer:] list, click the name of the printer you want to use, and then click [Setup].
- 4** Click [Configure].
A list of options appears.
- 5** Select the option you want to set up and select the appropriate setting for it.

Note

- If the option you want to set up is not displayed, the PPD file might not be set up correctly. Check the name of the PPD file shown in the dialog box.

- 6** Click [OK].
The list of options closes.
- 7** Click [OK].
The [Chooser] dialog box appears.
- 8** Close the [Chooser] dialog box.

INDEX

A

Access Control Address, 45, 49
Access Control Mask, 45, 49
ActiveProtocols, 45
AD370, 16
Agfa Font Manager, 53
Auto Run, 51, 52

B

Bypass Tray Type 270, 19, 32

C

configuration page, 37, 38
CS370, 22

E

Energy Star, ii

F

Firmware Version, 38
Font Download Free Memory, 38
Font Download Total Memory, 38
Frame type NetWare, 45

G

Gateway Address, 45, 49

I

Interchange Unit Type 280, 13
IP Address, 45

J

Job Control, 38

L

Language, 39

M

Macintosh
 setting up options, 63
Maintenance, 39
memory, 38
Multidirect Print, 53

N

Network Boot, 45
Network Cable Requirements, 40
Network Interface Board
 Operating Instructions, iv
Network Setup, 39

O

Options, 6
options, 38
options, setting up
 Macintosh, 63

P

PageMaker 6.0 or 6.5, 61
Pages Printed, 38
Parallel Cable, 41, 44
PCL 6/5e
 Windows 3.1x - Install, 56
 Windows 95/98 - Install, 55
 Windows NT 4.0 - Install, 55
PostScript
 Windows NT 4.0 - Install, 58
PortNavi, 53
PortNavi Operating Instructions
 Supplement, iv
PostScript
 Windows 3.1x - Install, 59
 Windows 95/98 - Install, 58
PostScript 3 Operating Instructions
 Supplement, iv
PostScript
 Macintosh - Install, 62
PPD, 63
Printer Driver, 55, 56, 58, 59
Printer Feature Expander Type 185, 24
Printer Hard Disk Type 185, 25
Printer ID, 38
PRINTER MANAGER FOR
 ADMINISTRATOR, 53
PRINTER MANAGER FOR CLIENT, 53
Printer Reference, iv
Proof Print Free Memory (A4), 38
Proof Print Total Memory, 38
PS400, 10
PS420, 10, 31
PS440, 10

R

reference, 38

S

Setup Guide, iv

Subnet Mask, 45, 49

T

Toner Bottle, 27

Total Memory, 38

